

# Houdini Harness Model 27

## Installation and User Manual



### **IMPORTANT!**

Scan to watch a video on the **correct** way to install this Houdini Harness



#### IMPORTANT CONSUMER INFORMATION NOTICE:

This manual contains important instructions that must be passed on to the user of this product. Please do not remove this manual before delivery to the end user.

#### SUPPLIER:

This manual must be given to the user of this product.

#### USER:

Before using this product, read entire manual and save for future reference.

User Manual for all Houdini 27 Harnesses  
Manual: Houdini27201504

- SIZE "A" - SMALL  
#4604-2702-017
- SIZE "B" - LARGE  
#4604-2703-017
- ANTI-ESCAPE BUCKLE  
A#4604-2702-026 B#4604-2703-026
- PEN/KEY RELEASE UPGRADE  
#4604-2805-031
- CUSTOM: \_\_\_\_\_

Considerations with  
Houdini Vehicle Harnesses



Serial Number:

# Model 27 STEEL

Designed to offer postural support and a certain degree of restraint to children and adult to keep them in an upright sitting position.

Model 27 will fit:

- Single vehicle seats, including low or high backed
- Split Backed double seats, including low or high backed
- Aircraft seats by many leading Airlines
- Other types of single seating.

Available in three Sizes:

Up to 5 yrs	27ISB
5 yrs to 8 yrs	27ASB
9 yrs to Adult	27BSB

The harness consists of a full body harness connected to a back pad which is fitted horizontally around the vehicles seat back with two horizontal fixing straps.

Model 27 is used on aircraft seats by many leading airlines. The two horizontal straps do not interfere with the passenger behind using the drop down trays.

**We always advise our clients to seek permission from the airlines to use our harnesses prior to departure.**

The waist belt on this harness is fitted with a Steel Safety buckle for those passengers with inquisitive fingers that can undo the press release buckle.



## IMPORTANT:

**This harness is not classed as a safety harness. The vehicle safety belt MUST be worn over the top of our harness unless they are exempt for medical reasons.**

## Optional Extra

A Houdini Stop can be fitted to this harness.

This chest strap ensures the passenger stays safely and correctly positioned within their harness.

It simply clips on to each shoulder strap of the harness to help prevent the passenger from separating the shoulder straps in order to escape.



M.27A - 5 yrs to 8 yrs



M.27 Fixing Straps

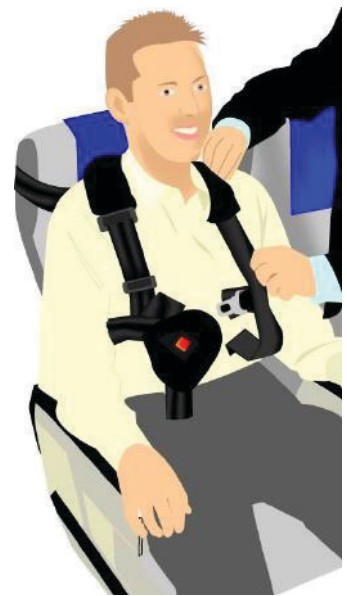

M.27A fitted to an aircraft seat

Crelling Harnesses For Disabled Ltd.

12 Crescent East, Thornton-Cleveleys, Lancashire, FY5 3LJ

Tel: 01253 852298 Fax: 01253 821780 Email: [info@crelling.com](mailto:info@crelling.com) Website: [www.crelling.com](http://www.crelling.com)

# Model 27 Press

Designed to offer postural support and a certain degree of restraint to children and adult to keep them in an upright sitting position.

Model 27 will fit:

- Single vehicle seats, including low or high backed
- Split Backed double seats, including low or high backed
- Aircraft seats by many leading Airlines
- Other types of single seating.

Available in three Sizes:

Up to 5 yrs	27I
5 yrs to 8 yrs	27A
9 yrs to Adult	27B

The harness consists of a full body harness connected to a back pad which is fitted horizontally around the vehicles seat back with two horizontal fixing straps.

Model 27 is used on aircraft seats by many leading airlines. The two horizontal straps do not interfere with the passenger behind using the drop down trays.

**We always advise our clients to seek permission from the airlines to use our harnesses prior to departure.**

The waist belt on this harness is fitted with a Press Release buckle for those passengers who won't undo the buckle or need to be released quickly from the harness

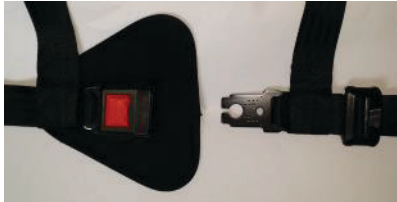

### IMPORTANT:

**This harness is not classed as a safety harness. The vehicle safety belt MUST be worn over the top of our harness unless they are exempt for medical reasons.**

### Optional Extra

A Houdini Stop can be fitted to this harness.

This chest strap ensures the passenger stays safely and correctly positioned within their harness.

It simply clips on to each shoulder strap of the harness to help prevent the passenger from separating the shoulder straps in order to escape.



M.27A - 5 yrs to 8 yrs



M.27 Fixing Straps

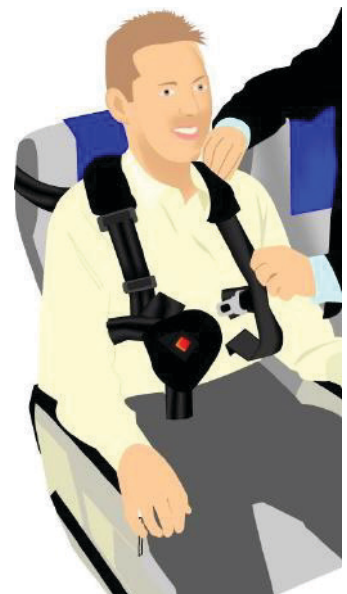

M.27A fitted to an aircraft seat

Crelling Harnesses For Disabled Ltd.

12 Crescent East, Thornton-Cleveleys, Lancashire, FY5 3LJ

Tel: 01253 852298 Fax: 01253 821780 Email: [info@crelling.com](mailto:info@crelling.com) Website: [www.crelling.com](http://www.crelling.com)

# Model 27 Fitting Instructions

NB. A fitting video can be found on our website - <https://crelling.com/model-27.html>

1. If fitting a brand new harness, remove any Rubber Bands & unfasten the two Horizontal Fixing Straps [a].
2. Place the back pad [g] of the harness against the front of the back rest & pass the two the Horizontal Fixing Straps around the seat back.
3. Feed the tail-ends of the two Horizontal Fixing straps through the Aluminium Bar Buckles (see diagram [b]) & pull to tighten around the seat back as securely as possible.
4. Each tail end should then be passed through the Sliplock Slide [c] to prevent the Fixing Straps [a] from loosening during transit.

[a] Horizontal Fixing Straps



5. Unfasten the Waist Belt & position the Understrap [f] centrally on the seat cushion
6. If the passenger is under 135cm place a Booster Seat or Cushion on top of the Understrap to comply with child seat safety legislation (See last page for further information)
7. Position the Back Pad [g] & Body Harness on the seat so that the waist belt will be in line with the waist when the passenger sits down.
8. The harness is now ready for the passenger to be seated.
9. With the passenger sitting in the most upright position as possible, bring their arms through the shoulder straps [d].
10. Now bring the understrap [f] up between the legs and loop it back onto the waist belt over the buckle [e]
11. Connect the waist belt buckle [e] to fasten the harness. Position the buckle centrally at waist level on the passenger. Nb. The Waist Belt can move freely through the leatherette Back Pad [g]
12. Adjust all straps to fit tightly yet comfortably by pulling the tail-ends of strapping through the Adjuster Buckles [i].
13. If using the Houdini Stop Chest Strap [j], attach to Shoulder Straps **underneath the Adjuster Buckles** [i]. See instruction provided.
14. Ensure that the three Comfort Pads [g] are in position over the Adjuster Buckles [i] on the Shoulder & Under Straps.
15. **Fasten the vehicle safety belt over the top of the Model 27 Harness.**
16. To remove the passenger from the harness - Unfasten the buckle on the waist belt at the centre-front.

## 40mm Adjuster Buckle

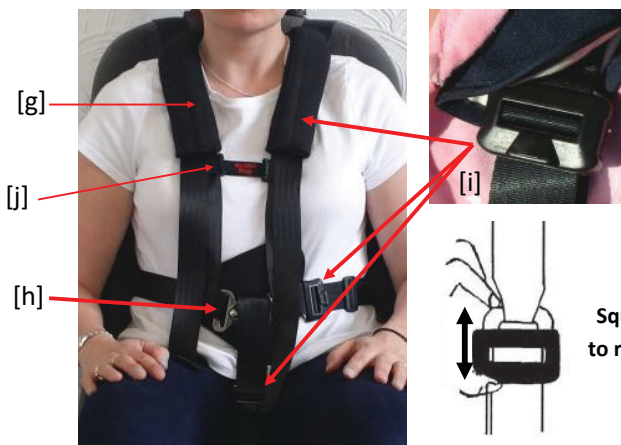

### To Extend Straps

The 40mm Adjuster is slightly spring loaded to lock the webbing into position.

To release the webbing you need to squeeze the Adjuster whilst pulling on the lower webbing strap.



### To Tighten Straps

Simply pull the tail-end of the webbing strap.

The Adjuster will lock the webbing into position

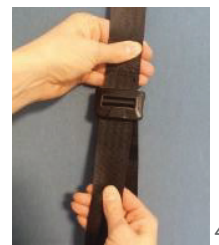

## 50mm Aluminium Bar Buckle



Webbing is threaded through the sliding bar buckle

## Sliplock Slide

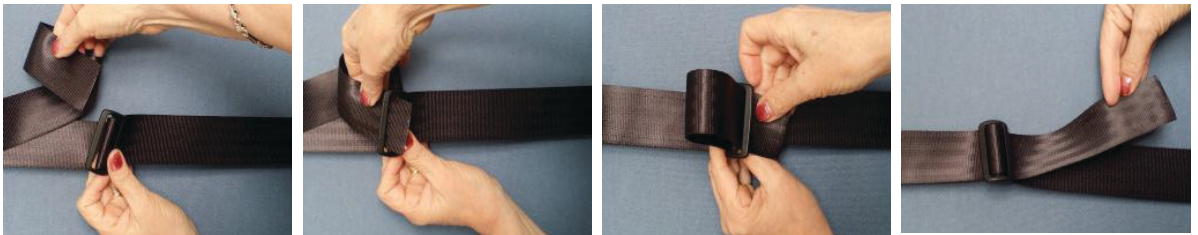

Loose ends of webbing are often passed back through these slides to prevent slippage & to prevent the Fixing Straps from loosening during transit.

## Steel Safety Buckle

This buckle has proven extremely successful when fitted to our harnesses as an alternative to the standard 'quick release' buckle. It helps prevent those passengers with inquisitive fingers, challenging behaviour or learning difficulties from releasing the harness buckle.

The buckle operates in reverse to the standard vehicle buckles as it is opened by raising a spring loaded lever or over-catch and **will not press release**. The spring loaded over-catch locks the buckle when assembled and prevents accidental opening.

There is a knurled sliding bar for adjustment designed to prevent webbing slip.

The buckle is made from Type 316 Stainless Steel and Nylon 6 and is assembled with tamper proof screws.

The 40mm buckle has a Breaking Strain of 630 kg

We recommend that the buckle instructions provided with each harness are displayed in a prominent position in the vehicle - to instruct the carer how to release the buckle mechanism in the event of an accident.



## Emergency Seat Belt Cutter (Optional Extra)

We strongly recommend that a seat belt cutter is kept in the vehicle as a safety precaution for those harnesses fitted with a Steel Safety Buckle.

A simple but effective device for ensuring the occupants of a car are able to exit quickly and safely, particularly in the overturned car.

It is perfectly safe as the blade is encased.

Cat. Ref: SK



## Comfort Sleeves

Velcro Comfort Sleeves will be supplied with each harness.

These can be fitted around the shoulder Straps & under strap where required.



# Model 27 Being fitted to a Monarch Aircraft Seat



Accepted for passengers with special needs by many airlines Including:



50mm Aluminium Bar Buckle



50mm Slielok slide

## Booster cushions



All our range of children's vehicle harnesses can be used in conjunction with booster cushions

## Booster Seats

**IMPORTANT: Our harnesses must NOT be used with child car seats already fitted with the 5 point harness.**

Height-adjustable  
headrest



Britax Adventure  
15 to 36kg (approx. 4 to 11 years)

The **Model 27** harness can be used on some high backed booster seats with height-adjustable headrests, which extend to grow with the child such as the **Britax Adventure**.

Some of our customers have found that they work very well together offering postural support or extra security for those with learning difficulties.

**NB. It is often necessary to purchase Model 27 harness in a larger size harness to accommodate the child car seat.**

- The model 27 harness is fitted directly onto the vehicle seat first, prior to fitting the high backed booster seat.
- The high backed booster seat is then fitted onto the vehicle seat.
- The shoulder straps and waist belt of the Crelling harness are then brought around the booster seat.
- The shoulder straps should slot between the shoulder of the booster seat & the head rest.
- The harness is now ready for the child to get into.
- Place the child into the booster seat & fasten the harness according to the Model 27 fitting instructions.
- Once the child is securely & comfortably fastened in the harness, **fasten the vehicle seat belt over the top of our harness** ensuring that it passes through the 'belt guides'.
- Please ensure that the high backed booster seat is fitted according to the manufacturers instructions & the head rest is adjusted correctly. A properly adjusted headrest ensures the optimum distribution of the diagonal belt & provides your child with the desired protection and comfort.



**IMPORTANT: This harness is not classed as a safety harness.**

The vehicle safety belt **MUST** be worn over the top of our harness unless they are exempt for medical reasons. The combination of the existing safety belt & the secondary harness offers added security for the passenger.

# Crelling Harnesses For Disabled Ltd.

12 Crescent East, Thornton-Cleveleys, Lancashire, FY5 3LJ

Tel: 01253 852298 Fax: 01253 821780 Email: [info@crelling.com](mailto:info@crelling.com) Website: [www.crelling.com](http://www.crelling.com)

## Model 27 for Aircraft Use

The **Model 27** vehicle harness has been accepted for use by many airlines. The two horizontal fixing straps do not interfere with the passenger behind using the drop down tray. It is a full 5 point harness which provides good postural support & the under strap helps prevent the passenger from sliding down in their seat.

The Model 27 harness is **NOT FAA-approved**. It must be used in conjunction with the existing aircraft safety belt. NB. Some airlines will not allow passengers with certain disabilities to travel without our model 27 harness.

It is now widely accepted for passenger use by many airlines including:-

Monarch Airlines

Ryanair

Easy Jet

Thomas Cook

JMC Airlines, Manchester Airport

Britannia Airways

My Travel

British Airways

Virgin Atlantic Airways

Excel Airways

Falcon Airways, Dublin Airport.

Orkney & Aberdeen Airport

Balearia-Eurolineas Maritimas

Air Canada

Flybe

Scandinavian Airlines (SAS)

Thai Airways

LOT Polish Airlines

Air Europa

If the Airline is not familiar with our harnesses then they can arrange for us to supply them with a free sample harness that they can have for assessment.

**NB. As Model 27 is NOT FAA-approved. We always advise our customers to seek permission from the airline to use our harnesses prior to departure.**

We also recommend that you request permission in writing or get a contact name & telephone number to avoid any problems at the Airport.

It would also be a good idea to try the harness out on a single vehicle seat or dining chair before the flight. This will help you to become more familiar with fitting the harness, which will hopefully help save time when fitting it to the aircraft.



# Model 27 Being fitted to a Monarch Aircraft Seat



Accepted for passengers with special needs by many airlines Including:



50mm Aluminium Bar Buckle



50mm Sliplok slide

# Terms & Conditions

## General

We reserve the right to change these Terms and Conditions at any time.

It is your responsibility to read the Terms and Conditions each time you visit the web site and your use of the website will be deemed as your acceptance to be bound by the latest Terms and Conditions.

## Crelling Harnesses are not classed as Safety Harnesses

The vehicle safety belt **MUST** be worn over the top of all Crelling Vehicle Harnesses unless a Certificate of Medical Exemption from Compulsory Seat Belt Wearing has been issued by a Doctor / General Practitioner (GP).

The combination of the existing safety belt & the secondary harness offers added security for the passenger.

## Care & Maintenance Instructions

Care & Maintenance Instructions are enclosed with every order.

These **MUST** be read carefully before fitting a harness and followed for correct use.

## Quality Assurance

Every effort is made to maintain a high standard of quality and reliability through precise specification, inspection and testing. New and improved components are constantly being added and designs updated where appropriate.

Our products have been on the market for over 40 years and our designs have been developed and used successfully over this time.

We are a certified member of the British Healthcare Trades Association and abide by the BHTA Code of Practice and the British Chamber of Commerce.

We were awarded The Prestigious Award 2007 for businesses in the caring sector.

Our harnesses have been designed to provide extra postural support and help clients maintain an upright position when seated in most types of seating.

Many designs also offer a certain degree of restraint for those with challenging behaviour or learning difficulties.

**They are not safety harnesses and all vehicle harnesses should be worn in conjunction with the existing safety belt.**



## Cancellations

If you should decide to cancel your order, please advise us as soon as possible. We will also require confirmation of the cancellation in writing (email, letter or fax) giving us your purchase order details (including official Purchase Order No. where applicable).

If the cancellation is advised to us after the order has been despatched, you will be responsible for any courier/postage charges for its return.

**NB.** Your right to cancel an order starts the moment you place your order and ends 14 days from the day you receive your goods.

If your order consists of multiple goods, the 14 days runs from when you get the last of the batch.

This 14 day period is the time you have to decide whether to keep the goods or not and you then have a further 14 days to actually send the goods back to us.

If there are special circumstances where it is not possible to return items within this 14 day period please contact us to discuss the matter as we do try to be flexible to meet your needs.

## Your right to a refund

You should get a refund within 14 days of either our company receiving back the returned goods, or you providing evidence of having returned the goods to us (for example: a proof of postage receipt from the post office etc.), whichever is sooner.

A deduction can be made if the value of the goods has been reduced as a result of you handling the goods more than was necessary. Goods should be returned in as new and clean condition.

We will refund the cost of the goods plus the basic delivery cost (excluding the packing charge) of getting the goods to you in the first place, so if you opted for enhanced service to return goods, for example: Guaranteed Next Day, we will only refund the basic postage cost.

## Returning faulty goods

On delivery, the purchaser shall carry out a visual examination of the goods and shall notify the company within fourteen (14) days of any defect revealed by such examination. Without such notification, we will deem the goods satisfactory in respect of any defect that such an examination should reveal.

From time to time some products may develop minor faults. Should this happen during your guarantee period we can arrange for your goods to be repaired or replaced where necessary.

## Payment

Once we have received your order and checked our stock availability the payment will be processed.

Goods are subject to availability and in the event that we are unable to supply your request, we will notify you as soon as possible. In this case, any goods that have been paid for will be fully refunded.

## Security

At Crelling Harnesses Ltd. we take Security very seriously.

Our Payment processing partner uses the latest security to ensure that your credit card details are always protected when you shop online.

When shopping online Crelling Harnesses Ltd. never receives your credit card information, this is all taken care of by our processing partner.

## Privacy Policy

Crelling Harnesses Ltd. does not disclose any information on its customers to any third party on any occasion. Please see our [Privacy Policy](#) for further information.

## Guarantee

All our products are fully guaranteed for 12 months from the date the goods are supplied.

If the product you have purchased develops a material or manufacturing fault within 12 months of purchase, and the fault has not been the result of abuse, misuse or negligence, incorrectly fitted or normal wear and tear, return it to Crelling Harnesses Ltd. with proof of purchase.

We recommend that you keep your receipt in a safe place.

We reserve the right to return the product to the original manufacturer where appropriate, to determine the nature of the fault.

We will, at our discretion, repair, replace with same or similar item, or refund the cost of the product.

Any postage charges incurred in returning the goods will be reimbursed.

Your statutory rights are not affected by this guarantee.

## Get Wise to making a complaint

We are an approved member of the BHTA which represents healthcare and assistive technology products and services in the U.K. As a BHTA member we have signed up to a special Code of Practice which has been granted full Office of Fair Trading approval under the Consumer Codes Approval Scheme (CCAS).

If you've just bought a product and for whatever reason, are not happy with it, please contact us

Please also see the **BHTA 'Get wise to making a complaint'** leaflet that aims to explain how to go about it. This leaflet is enclosed with every order. It can also be downloaded from our website -

[www.crelling.com/information.html](http://www.crelling.com/information.html)

## If you have any queries regarding our products please contact us:-

Crelling Harnesses Ltd.

12 Crescent East

Thornton-Cleveleys

Lancashire

FY5 3LJ

**Tel:** 01253 852298 - Calls can be taken between 09:00-12:00 & 13:30-16:00, Monday to Friday.

**Fax:** 01253 821780

**Email:** [info@crelling.com](mailto:info@crelling.com)

# Care & Maintenance Instructions

Please read instructions carefully before fitting and follow them for correct use.

If there is any query or problem with the suitability of the product, please do not hesitate to contact us.

Retain these instructions for future reference.

It is most important that the operating & maintenance instructions are kept with each harness. Especially if being transferred to new users.

Additional copies of these instructions are available on request. They can also be found on our website.

## **IMPORTANT:**

Our range of harnesses are not classed as safety harnesses.

The vehicle safety belt **MUST** be worn over the top of our harness unless they are exempt for medical reasons.

The combination of the existing safety belt & the secondary harness offers added security for the passenger.

# General maintenance of our belts & harnesses

**Before each use check that the belt or harness is in a satisfactory condition and is appropriate for the user.**

**Ensure that all belts and harnesses are fitted, adjusted and used correctly.**

**It is also very important that they are maintained & cleaned in accordance with the instructions below:**

- We strongly advise that a carer, O.T. or G.P. etc. Who is familiar with the patients requirements is consulted prior to the selection of a harness. The clients condition together with the type of seating/equipment is most important in choosing the most suitable belt/harness. An inappropriate selection may prove uncomfortable or harmful for the occupant.
- Please refer to the appropriate fitting instructions for each model of belt or harness. These are enclosed with every harness. Additional copies are available upon request.
- Regularly inspect the belt or harness for damage, wear or malfunction. If any problems are identified replace it immediately.
- Belts and harnesses should be replaced if they show any sign of fraying or cuts.
- Regular checks are also necessary to assess the harness is still meeting the needs of the user as over time these needs may change.
- If the equipment was used during an accident, it should be replaced immediately.
- Avoid contact with corrosive liquids and keep the webbing away from sharp edges.
- If storing a harness with a PVC/Leatherette chest or back pad, do not fold. This may create creases which could cause discomfort to the passenger.
- Do not attempt to modify the equipment,. Any modifications to our belts or harnesses will void the warranty.
- If there is any query or problem with the suitability of the product, please do not hesitate to contact us.

# Washing Instructions

- All webbing and components can be cleaned by hand as necessary.
- HAND WASH ONLY . Do not machine wash or tumble dry.
- Please use warm soapy water (up to 70/80°) and a clean soft cloth.
- Mild detergent, anti bacterial wash, disinfectant or a mild spray disinfectant can be used - but do not use products containing bleach.
- Rinse with clear water, and allow to air dry.
- **IMPORTANT:** when cleaning or disinfecting do not immerse buckles in disinfectant or water.

## Transport of Special Needs Passengers

**Disabled children and adult passengers travelling in vehicles should always wear a safety belt or special restraint during transport.**

**Our range of vehicle harnesses are not designed to replace the seat belt but work in conjunction with it to offer both safety plus support and in some cases a certain degree of restraint.**

- The existing seat belt fitted in the vehicle may not offer sufficient support to the more severely disabled and it may be necessary to provide an extra restraint to hold the passenger in an upright sitting position, in combination with the seat belt.
- Front seat, disabled passengers in vehicles, frequently fall sideways out of the diagonal section of the seat belt, especially going around corners or sudden braking. two vertical static shoulder straps would offer additional support.
- The law requires all children travelling in cars to use the **correct child car seat** until they are either 135 cm in height or the age of 12 (which ever they reach first). After this they must use an adult seat belt.  
if the passenger is under 12 years or 135cm, please refer to our 'Child Seats & Suggested Products' literature to ensure the child is using the correct child seat & to see which of our products can be used.

- Special Needs passengers should never be left unattended whilst using any item in our range. Belts, harnesses or products should only be used whilst under the constant supervision of a parent, carer or guardian.

**IMPORTANT: Our range of harnesses are not classed as safety harnesses. The vehicle safety belt MUST be worn over the top of our harness unless they are exempt for medical reasons. The combination of the existing safety belt & the secondary harness offers added security for the passenger.**

## Booster Cushions



Illustrating one of our harnesses fitted in conjunction with the existing vehicle safety belt.

Booster cushions can be used in conjunction with all our range of vehicle harnesses.

This helps to raise the child to the correct height for wearing the vehicle safety belt.



For current laws and guidelines please visit:

[www.rospa.com](http://www.rospa.com)  
or  
[www.childcarseats.org.uk](http://www.childcarseats.org.uk)