

Version 012

INSTRUCTION FOR USE

# Junior

## Size 1

Max user weight: 50 kg  
Weight of product: 39 kg

## Size 2

Max user weight: 50 kg  
Weight of product: 39.5 kg

## Size 3

Max user weight: 50 kg  
Weight of product: 40.2 kg



Important Information: These instructions must be kept with the product at all times. This product is a prescribed Medical Device. To be used only under the guidance of a Therapist or Prescribing Practitioner. You must read these instructions carefully before use.

INSTRUCTION FOR USE

# Junior

Note: Some fabric and plastic colours may vary, adjustments are not affected.



# Contents

## General Information

Safety Labels .....	7
Basic Safe Configuration .....	8
Care and Cleaning Instructions .....	8
Maintenance .....	9
Product Induction & Hand Over .....	10
Specification & Warranty .....	11
Main Features and Benefits .....	12

## Frequent Adjustments

Lap Strap.....	15
Castors.....	20
Seat Height .....	21
Flip Away Foot Pedal.....	22
Tilt-in-Space.....	23
Footplate .....	24

## Clinical Adjustments

Back Angle.....	27
Back Pad & Lumbar Pad .....	27
Hip Guides .....	28
Seat Depth .....	28
Seat Pad & Abduction Roll .....	29

## Optional Accessories

Seat Extension.....	31
Headrests.....	32
Multigrip Headrest .....	35
PU Adjustable Headrest .....	36
Shoulder Protractors.....	37
Push Handle.....	38
Thoracics.....	39
Armrests.....	41
Tray .....	42
Activity Frame & Grab Bar .....	44
Elbow Blocks & Chest Pad for Tray .....	45
Hip Pad Extension .....	46
Kneeblocks .....	47
Abduction Block .....	48
Sandals and Bootees.....	49
Waistcoat Harness.....	50
Box Footplate.....	52

## Maintenance and Inspection

Maintenance & Inspection .....	54
Frequently Asked Questions.....	56
Notes .....	56



# Important Safety Info



This product must be thoroughly inspected by a qualified person at least annually



Ensure that your Therapist has confirmed that the product is correctly set up, by signing the 'Set Up' section of the Log book before using this product. If the product has not been set up by your Therapist DO NOT USE.



Jenx Limited recommends that children are never left unattended whilst using this Medical Device. Children may slip or fall when unattended and may suffer serious injury. It is the sole responsibility of the person caring for a child using this Medical Device to ensure the safety of the child in the Device should they be left alone.



Always read the instructions before operating. Failure to read and follow the Instruction for Use, especially with regard to moving parts, may pose a risk to the user.



Do not use this product if you suspect or know that it is broken or faulty. Please contact Jenx Limited immediately for advice: Jenx Limited, Tel: +44 (0)114 285 3376.



This product contains small parts which could present a choking hazard to small children.



All Jenx Limited products are tested to meet current Fire Safety regulations. Always keep products away from; naked flames, cigarettes and sources of heat such as heaters.



Jenx Limited supplies the necessary tools to adjust each product. These tools are supplied for use by trained therapists only. Store the tools in a safe place and keep away from children.



Assemble product fully before use. Please contact Jenx Limited if you have any problems at this stage. Jenx Limited, Tel: +44 (0)114 285 3376.



Ensure that good care is taken of your product: clean regularly. Do not use abrasive cleaners. When not in use, store this product in a dry place that is not subject to extreme temperatures. Places not to store this product include garages, attics or garden sheds.



All belts and harnesses should be used at all times. For therapy purposes it may be necessary to deviate from this rule and any deviation should be fully documented as part of a Risk Assessment or Therapy Program and all relevant staff and carers appropriately trained. Secure client with straps before adjusting product. Ensure finger's width between safety strap and client to prevent over tightening or client moving to inappropriate position. Adjust straps for each client and changes of clothing. Minimum Velcro® overlap: 3 inches (7.5cm) on all straps. If strap is not long enough: DO NOT USE PRODUCT.



This product conforms to the European Medical Devices Directive. It has not been tested in conjunction with other manufacturer's products. Do not add any accessories other than Jenx Limited accessories to this product. If in doubt, contact Jenx for advice +44 (0)114 285 3376.



Any changes or alterations carried out by persons other than a Jenx authorised service person will invalidate the warranty and Jenx can accept no liability for any injury or damage so caused.



All Jenx products are Medical Devices and are sold on the understanding that they will be prescribed, issued and maintained in line with current national device management guidelines.

# Key



## Key to Components



Wing knob



Allen key bolt



Swiss clip



T-Nut



Wing nut

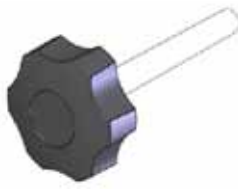

Star knob



Plastic spacer



Plastic washer

## Key for Users



Carers and home users



Re-issue and stores



Professional and technical users



Scallop wheel

CHAPTER ONE

# General Information



# Safety Labels



## Serial Number/ CE Certification

The serial number is written on the CE label (see picture), which is located on the product. Please quote this number on all correspondence.

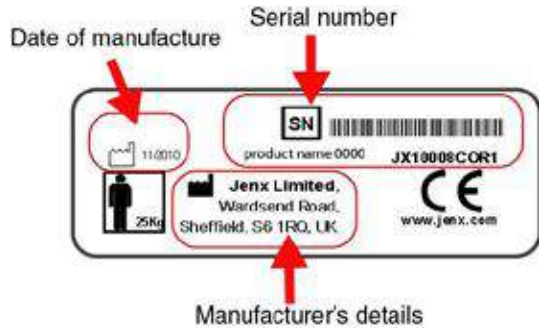

## Product Labels

Each Jenx product has a number of pictorial safety labels attached, these refer to the explanations below.



Attention/ Warning

Please read Instruction for use

Only for indoor use

Always fasten and adjust positioning straps and belts to suit the child. Adjust to suit changes in clothing. Allow one fingers width between the belt and the child

Do not leave child unattended (see page 4 for full warning)

DO NOT USE as a mobility device  
Never use product on rough ground or uneven surface



Client weight Limit (changes per model and size)



Conforms to CE Marking Regulations  
Medical Devices Directive (MDD) 93/42 EEC

# Basic Safe Configuration



The following features must be kept on the Junior at all times: Seat base, Seat back, Lumbar pad, Lap strap, Hip Supports and Footplate. Failure to use these basic features may pose a risk to the user. Other accessories can be added but these basic features must always be used.

## Care and Cleaning Instructions

### Fabrics, Vinyl and PU (polyurethane)

- Minor spills can be removed with a damp cloth
- Spillages should be removed as quickly as possible after contact, dab the stain, do not rub
- Do not over wet the stain
- Do not use organic solvents, dry cleaning fluids, abrasive cleaners or industrial bleaches
- Antibacterial spray or wipes can be used
- Always ensure that the product is dry before use

### Wooden Products and Parts

- For deep cleaning a low pressure steam cleaner can be used
- Do not use organic solvents to clean Jenx Products
- Soap and water or antibacterial spray can be used
- Check for breaks or splintering of the wood before re-issuing
- Daily cleaning: Spray polish or wax polish can be used

### Metal Frames and Coated Parts

- For deep cleaning a low pressure steam cleaner can be used
- Do not use organic solvents to clean Jenx products
- Soap and water or antibacterial spray can be used
- Daily cleaning: Wipe framework down with a damp cloth as necessary



# Maintenance



## Daily Checks

Daily checks of the equipment should be carried out by carers. These checks are not technical but a basic understanding of the product is needed. Multiple daily checks may be needed in schools or therapy rooms where the products are used by multiple users. The checks should include the following points:

- Replace any lost or worn washers or bolts
- Check tray for damage. Ensure that the tray edging is secure and that the tray is clean and free of any rough or sharp corners
- Check all upholstery for any signs of wear and tear
- Brush Velcro® to remove fluff
- Check wooden parts for splitting or splintering
- Check straps for fraying and missing or broken buckles
- Clean any stains or spillages
- Contact Jenx Limited if any accessories not manufactured by Jenx Limited have been attached to the product. Unauthorised accessories may affect the safety of this product and invalidate your warranty
- Check that gas spring levers are not bent. Do not use the product if any levers are bent. Contact Jenx Limited to arrange replacement

## Monthly Checks

We recommend that on a monthly basis a competent person who is familiar with this piece of equipment and who has been trained in its use should carry out a more detailed check:

- Check that all nuts and bolts are in place and secured
- Check that all mechanical movements operate fully
- Check the structure of the product for signs of fatigue
- Castors: Lift base and check each wheel to ensure it is not loose or worn. Remove any grease or dirt that has built up on the wheels, check that the brake stops the wheels rotating (where applicable)
- Check gas springs for normal operation and resistance. Slow descent (creeping) of the gas spring can be checked by observing the position of the unit over a period of time
- Check that gas spring levers are not bent. Do not use the product if any levers are bent. Contact Jenx Limited to arrange replacement

**If you have filled your product inspection log book, copies can be printed from [www.jenx.com](http://www.jenx.com)**



This product must be thoroughly inspected by a qualified person at least annually

# Product Induction & Hand Over



This product is a Prescribed Medical Device and as such it is important that all users understand the use and adjustments that this product offers. This booklet shows the range of adjustments and gives guidelines for each type of user to follow.

### Professional/Technical users

This refers to the Therapist and Prescribing Practitioner.

Ensure you read all sections in this booklet and are fully familiar with all the adjustments. As well as the selection, prescription and set up of the product to suit the client's needs, the technical user has the responsibility for the induction of the Carer, ensuring that the Carer:

- Has an understanding of the safety aspects of the product
- Is familiar with the product. What to use and what not to use
- Knows which accessories have been added and what daily adjustments to make
- Has an understanding of the care and cleaning procedures

A formal hand over procedure should be adopted for this product. Use the separate Inspection Log to record set ups and changes to the product. Jenx Limited offers Product Courses for Technical Users. Please contact us for more information.

### Carer (This section refers to the daily carer)

This product is a Prescribed Medical Device. It should only be used with the guidance of a prescribing professional. Do not make any adjustments other than those you have been instructed to make.

The Carer section of this guide gives the adjustments needed to aid daily use only, any other adjustments are only to be performed by the Therapist.

### Re-Issue (This section refers to Stores Personnel)

Stores personnel must follow the checks and maintenance guide before re-issue. The Medicines and Healthcare products Regulatory Agency (MHRA) releases regular bulletins regarding product updates and issues. These should be monitored.

- Records should be kept on all products serviced or re-issued
- Repairs or replaced parts should be traceable
- The Jenx serial number should always stay with the product and never be removed
- Instructions should always be issued with the product. Copies are available from Jenx Limited or can be downloaded from [www.jenx.com](http://www.jenx.com)
- Always inform the technical user before a product is issued to a home for set-up purposes
- If the product is to be re-delivered, ensure adequate and secure packaging is used
- If in any doubt as to the safety of this product do not issue it, contact Jenx Limited for advice
- Products must only be issued fully assembled, clean and in good working order. Instruction for Use must be with the product

Jenx Limited offer Technical User Courses for stores personnel. The course gives guidance for: maintenance, inspection of the products, regulatory information, cleaning. Please contact us for more information.

# Specification & Warranty



	Size 1 (JUC01)		Size 2 (JUC02)		Size 3 (JUC03)	
<b>Age range (approx.)</b>	18 months - 5 years		3 years - 8 years		5 years - 12 years	
<b>Max user weight</b>	50 kg		50 kg		50 kg	
<b>Base size (footprint)</b>	780 x 650		780 x 650		780 x 650	
<b>Back Angle</b>	15° supine 15° prone		15° supine 15° prone		15° supine 15° prone	
<b>Tilt-in-space</b>	30° supine 10° prone		30° supine 10° prone		30° supine 10° prone	
<b>All Dimensions in mm</b>	<b>Min</b>	<b>Max</b>	<b>Min</b>	<b>Max</b>	<b>Min</b>	<b>Max</b>
<b>Seat depth</b>	210	305	240	320	275	390
<b>Seat width (min/max)</b>	150	340	150	350	150	350
<b>Lower leg length</b>	195	270	250	365	250	405
<b>Back height (min/max)</b>	310	410	330	430	360	460
<b>Seat height from floor</b>	305	760	315	760	365	760

## Warranty

The Instruction for Use of this product should be followed carefully. It is impossible to eliminate all risks inherently associated with the use of this product. Product failure or other unintended consequences may result because of such factors as improper storage, use or maintenance, unauthorised and inappropriate alteration or repair or improper or violent treatment, excessive strain, use of improper replacement parts, or because of normal wear and tear, all of which are beyond the control of the Manufacturer and Seller. Buyer and User assume all such risks.

Manufacturer and Seller warrant that this product will be free from defects in material and workmanship for a period of 24 months from the date of purchase and is reasonably fit for the purposes stated in the Instruction for Use, subject to the inherent risks under normal use conditions. This Warranty does not extend to the use of the product contrary to the Instruction for Use, or under abnormal conditions, or under conditions not reasonably foreseeable to or beyond the control of the Manufacturer or Seller. Buyer and User assume the risk of any such use. MANUFACTURER MAKES NO WARRANTIES OF SATISFACTORY QUALITY OR OF FITNESS FOR A PARTICULAR PURPOSE NOR ANY OTHER EXPRESS OR IMPLIED WARRANTY EXCEPT AS STATED ABOVE.

In no event shall Manufacturer or Seller be liable for any incidental, consequential or special damages resulting from the use of this product. THE EXCLUSIVE REMEDY OF THE USER OR BUYER AND THE EXCLUSIVE LIABILITY OF MANUFACTURER AND SELLER FOR ANY AND ALL CLAIMS, LOSSES, INJURIES OR DAMAGES (INCLUDING CLAIMS BASED ON BREACH OF WARRANTY, CONTRACT, NEGLIGENCE, TORT STRICT LIABILITY OR OTHERWISE) RESULTING FROM THE USE OF THIS PRODUCT, SHALL BE THE RETURN OF THE PURCHASE PRICE OF THE PRODUCT OR THE REPLACEMENT OF THE PRODUCT.

Manufacturer and Seller offer this product, and Buyer and User accept it, subject to the foregoing conditions of sale and limitations of warranty and liability, which may not be modified except by written agreement signed by a duly authorised representative of the Manufacturer.

# Main Features and Benefits

Feature	Benefit
<b>WASHABLE COVERS</b>	Wide range of colour options plus a second seat pad cover
<b>LAP STRAP BUCKLE HOLDERS</b>	Tuck away lap straps for easy transfer, preventing lap strap from snagging under child
<b>HIP PADS</b>	Adjustable for width and angle, can be fitted with extensions
<b>INTEGRAL ABDUCTION ROLL</b>	To promote neutral leg position, removable PU for easy cleaning
<b>CONTOURED SEAT PAD</b>	Soft, easy clean PU with targeted memory foam insert
<b>ABDUCTION BLOCK FITTING</b>	Additional accessory for children with increased tone and tonal pull into adduction
<b>4 POINT LAP STRAP</b>	Hold ASIS in correct position for secure hip base
<b>SMALL FOOTPRINT</b>	Jenx Y base with convenient flip-away foot pedal and safety knob. Fits through most standard doors
<b>HEADREST OPTIONS</b>	Jenx Multi-grip, Oval, Memory Metal, and Stealth headrests can be fitted
<b>CONTOURED BACK PAD</b>	Soft, easy clean adjustable PU pad. Can be fitted with adjustable thoracics, elbow blocks, waistcoat harness or shoulder harness.
<b>BACK ANGLE</b>	Close angle for children with extensor thrust or open angle for more support for children with low tone or for children who are not comfortable with 90/90 seating. Adjustable from 15° prone to 25° recline
<b>LUMBAR &amp; THORACIC SUPPORT</b>	Soft, easy clean PU. Adjustable for height, angle and depth
<b>TRAY ARMS (not shown)</b>	Firm fit, easy clean arms with large wing nuts for easy height and angle adjustment, with improved height adjustment lock
<b>ISCHIAL BAR (not shown)</b>	Optional PU bar that helps to prevent child slipping into sacral sitting
<b>EASY-CLEAN TRAY (not shown)</b>	2 sizes available plus tray insert to reduce gap if required, grab bar, activity frame, tray padding, chest pad and elbow block accessories
<b>TRANSLUCENT TRAY INSERT (not shown)</b>	To hold and protect pictures and communication signs
<b>1 PIECE FOOTPLATE</b>	Adjustable flip-up for easy transfer. Use with or without sandals. Accessories include individual footplates, padded box footplate, footplate pad.
<b>EASY ADJUSTMENT</b>	Tool free or simple allen key adjustment, no need to dismantle or remove parts for access.
<b>LOCKING TILT-IN SPACE LEVER</b>	Prevents siblings and classmates changing the tilt-in-space angle

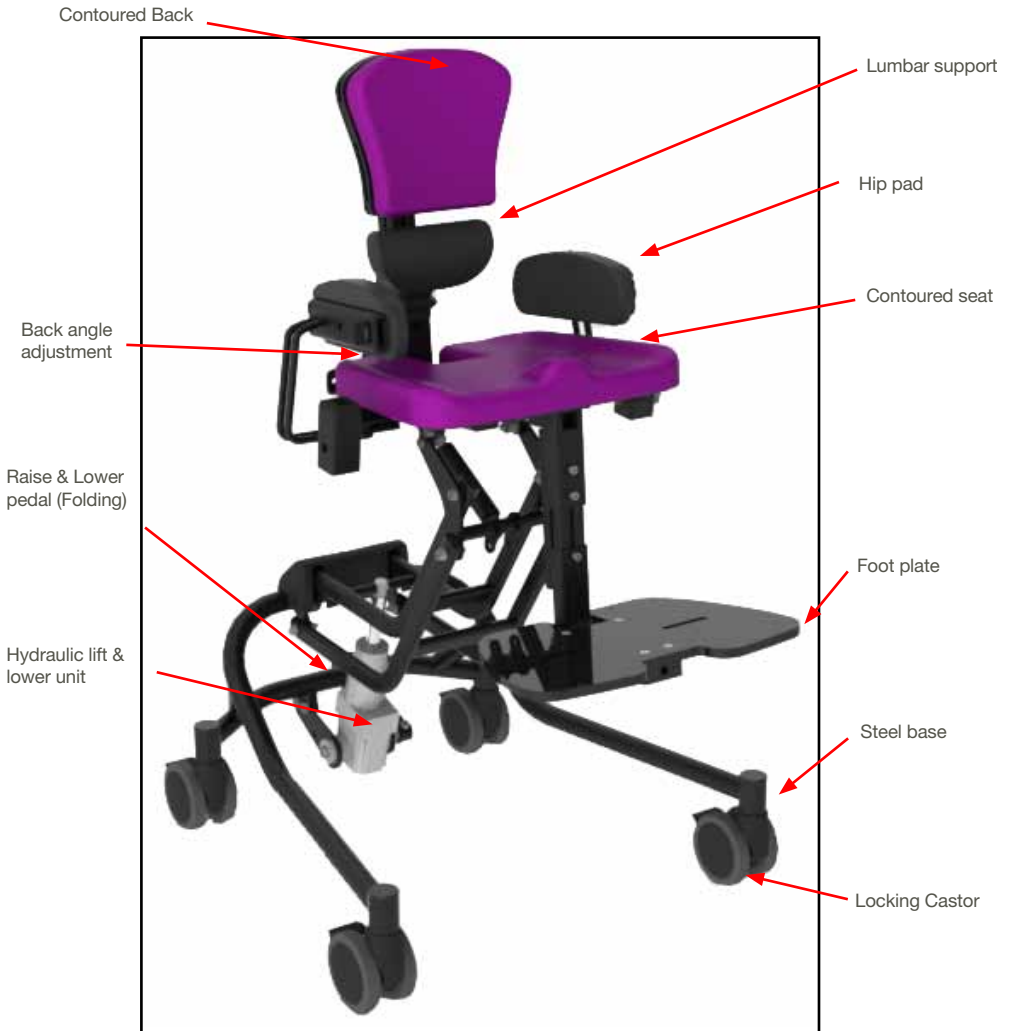

CHAPTER TWO

# Frequent Adjustments



# Lap Strap



The distance between the pads on the front of the strap is variable to accommodate the variation in the size of children

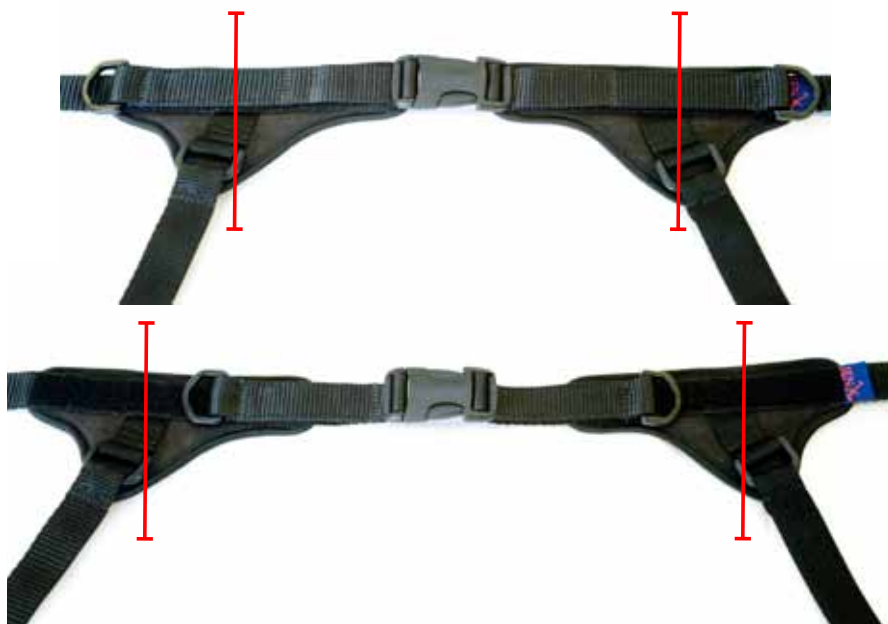

Adjust the distance between the pads so that the centre of the pads rest on the Anterior Superior Iliac Spines of the child



All belts and harnesses should be used at all times. For therapy purposes it may be necessary to deviate from this rule and any deviation should be fully documented as part of a Risk Assessment or Therapy Program and all relevant staff and carers appropriately trained. Secure client with straps before adjusting product. Ensure finger's width between safety strap and client to prevent over tightening or client moving to inappropriate position. Adjust straps for each client and changes of clothing. Minimum Velcro® overlap: 3 inches (7.5cm) on all straps. If strap is not long enough: DO NOT USE PRODUCT.

# Lap Strap



Pull the strap from the Velcro®



### To make the strap longer

Pull the buckle along both straps until the desired distance between the pads is achieved



### To make the strap shorter

Pull both straps through the buckle until the desired distance between the pads is achieved



All belts and harnesses should be used at all times. For therapy purposes it may be necessary to deviate from this rule and any deviation should be fully documented as part of a Risk Assessment or Therapy Program and all relevant staff and carers appropriately trained. Secure client with straps before adjusting product. Ensure finger's width between safety strap and client to prevent over tightening or client moving to inappropriate position. Adjust straps for each client and changes of clothing. Minimum Velcro® overlap: 3 inches (7.5cm) on all straps. If strap is not long enough: DO NOT USE PRODUCT.



# Lap Strap



When the straps are the required length press the straps against the Velcro® to secure them

## Placing the Child in the Chair

For a child with postural problems, the lap belt is often the most important adjustment you make on a chair, so please take care to do this properly every time and make sure that everyone who uses the belt with the child understands fully how to adjust it correctly.

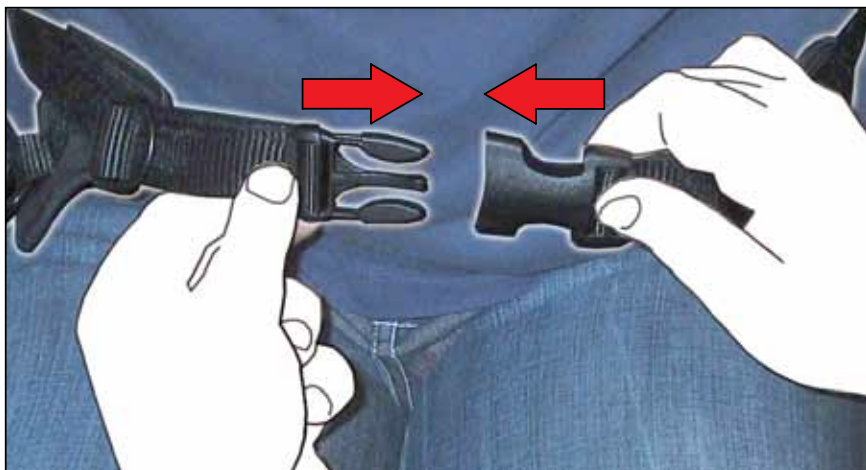

Place the child in the chair. Close the front buckle

# Lap Strap

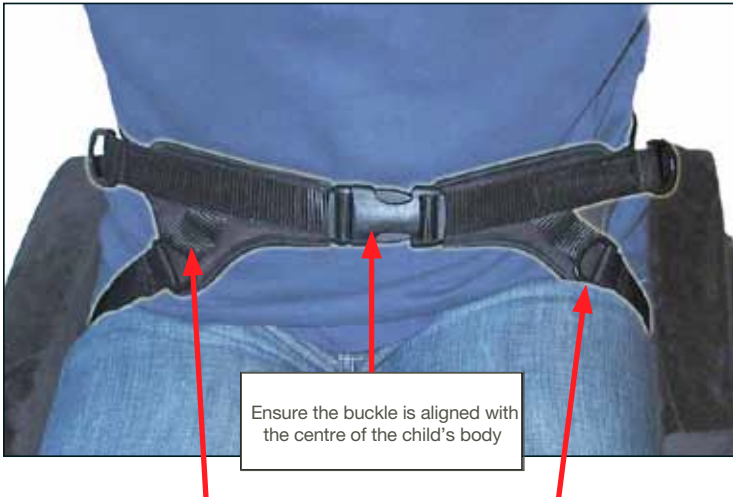

Adjust the long straps that pass through the cam locks at the rear and sides until the padded sections of the lap strap rest on the anterior superior iliac spines.

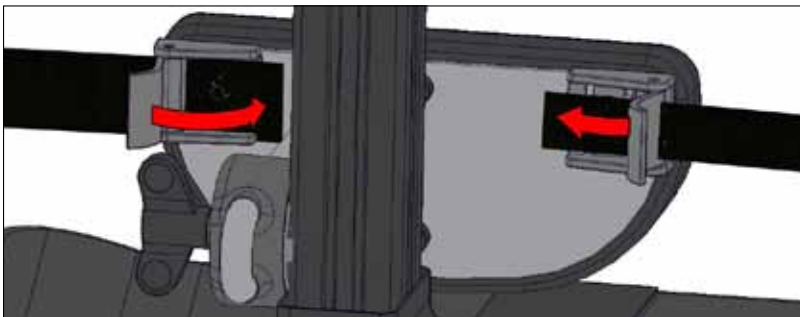

Lock the cam locks at the rear of the chair

# Lap Strap



Lock the cam locks at both side of the chair

## Fine Adjustment of the Lap Strap

When the Lap Strap is fitted it is possible to finely adjust its position



Adjust the pressure on the pelvis by tightening or slackening the straps equally, as shown



Press the strap against the Velcro® to secure it

# Lap Strap & Castors

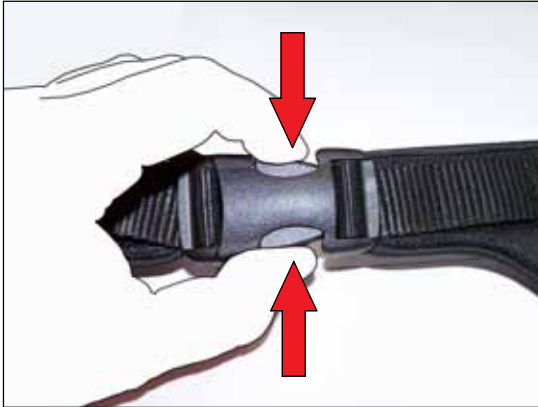

Press the buckle in the positions shown to release the buckle

## Castors



This product is supplied with four double locking Castors. The locking mechanism stops the Castors from turning and swivelling. When all four Castors are in the locked position this secures the chair from unintended roll or movement.

To lock the Castors gently push the lever down with your foot or hand.

To release the Castors simply lift the lever

# Seat Height



## Junior on Y Base

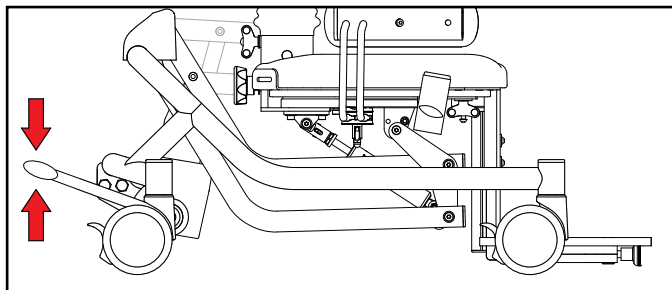

1. Press pedal to raise the chair height
2. Lift pedal with toes to lower chair



All four castors must remain on the ground at all times

## Junior on X Base

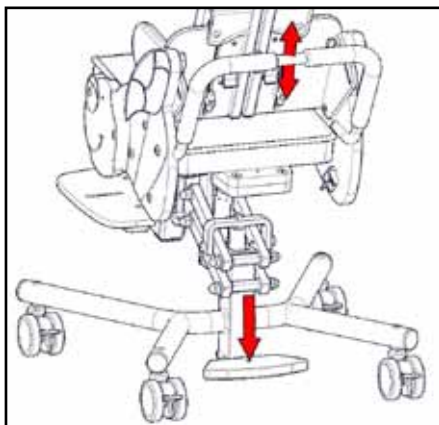

1. Press pedal to raise seat height
2. Press pedal and push down on handle to lower seat

Note: Image shown of Bee, Junior adjusts in the same way

### Why? Benefits of the Adjustment:

Height adjustment is used for seating for two main reasons:

To suit the lower leg length of the child so that they sit with their feet as near to the floor as possible. This allows a child to sit at a similar height to other children in the group and aids social interaction.

To bring the child to a particular height such as a dining table or a breakfast bar. In this case the footplate should be used to give the child support and the seat height adjusted to suit the surface.

# Flip Away Foot Pedal



**Why? Benefits of the Adjustment:**

The Foot Pedal can be tucked away under the chair to prevent accidental operation.

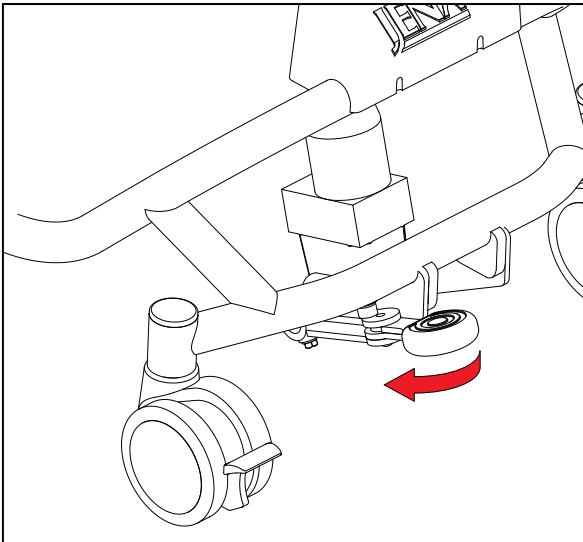

The Pedal is held in place by friction.

Push the Foot Pedal under the chair.

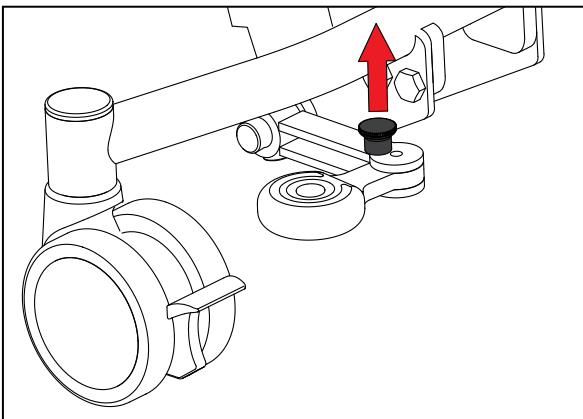

The Pedal can be locked closed by engaging the Plunger.

It is unlocked by pulling the plunger up and swinging the Pedal out

# Tilt-in-Space



**Why? Benefits of the Adjustment:**

By altering the position of your child in space, you can help them to perceive the environment that surrounds them in different ways and thereby help their cognitive development. By putting the chair into prone you may improve your child's head control and arm function.

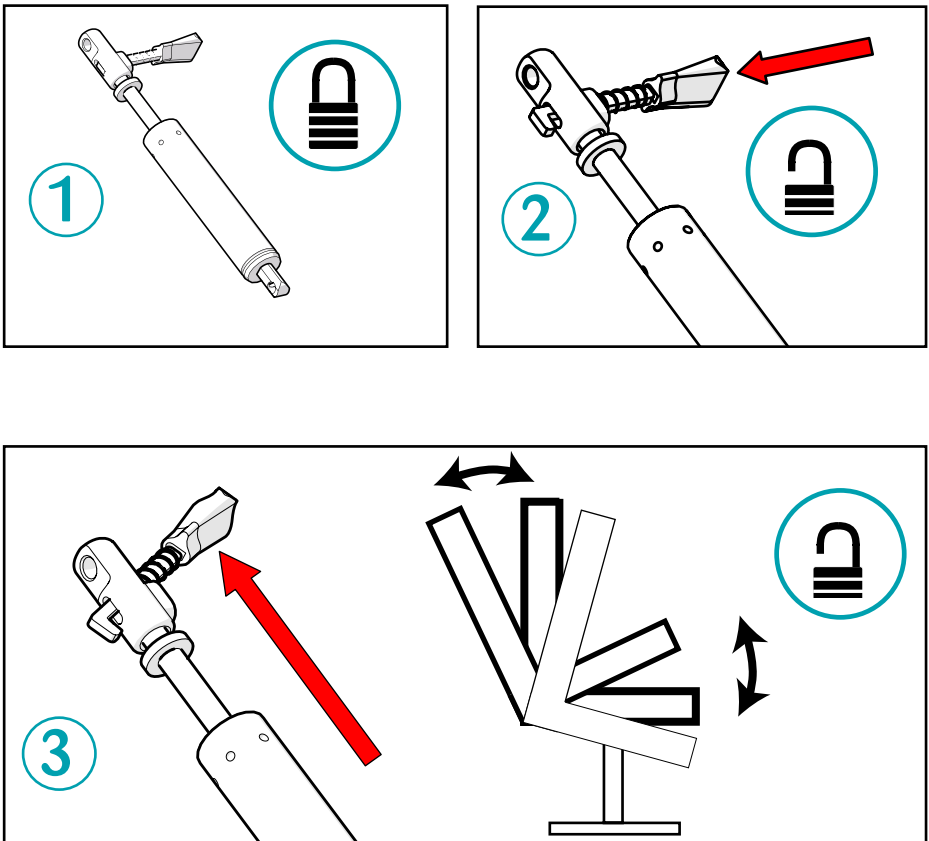

# Footplate



**Why? Benefits of the Adjustment:**

Set the Footplate height to suit the length of your child's lower leg. .... As the child grows, adjust the Footplate height accordingly.

WHY?

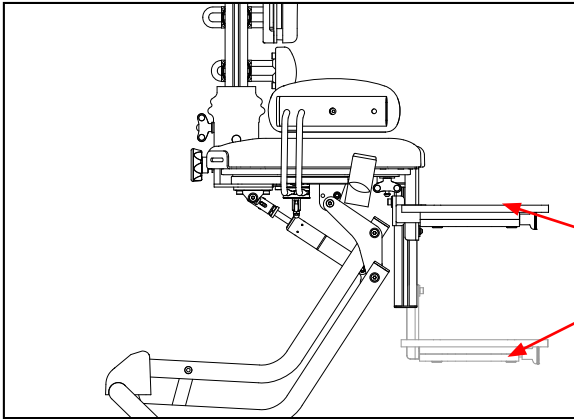

The range of the Footplate movement

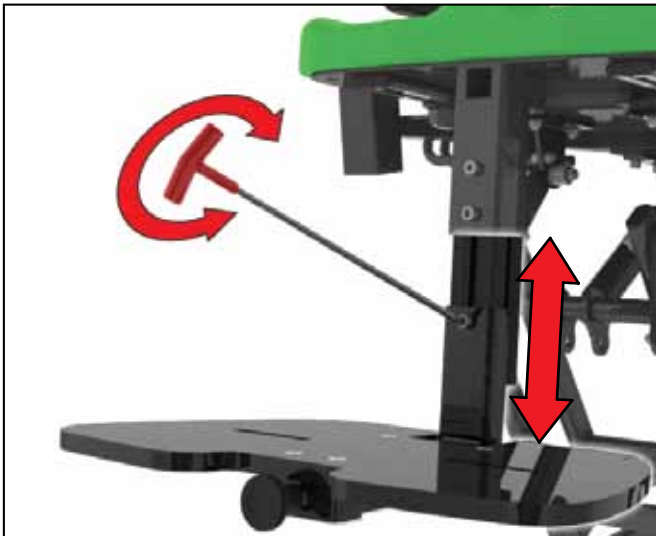

Loosen the bolt and adjust the Footplate to the desired height. Tighten the bolt.



# Footplate



## Flip-up Footplate

### Why? Benefits of the Adjustment:

The Footplate flips up out of the way to aid placing and removing your child to and from the chair.

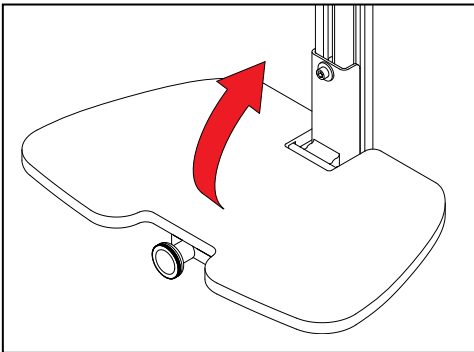

Simply lift the foot plate and place it against the footpost. The magnet in the footpost will hold it in the upright position.

## Footplate Angle

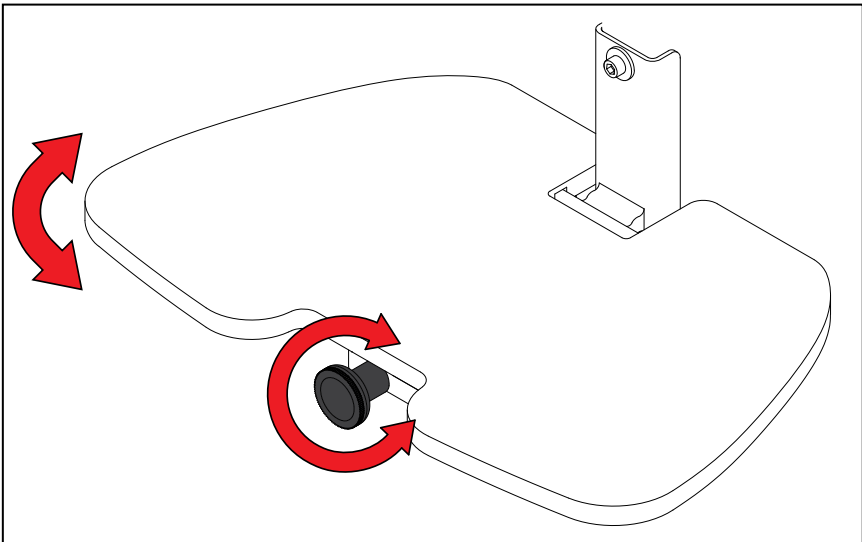

CHAPTER THREE

# Clinical Adjustments



## Back Angle



Loosen the locking wing knob



Rotate the scallop wheel until the desired back angle is achieved

Tighten the locking wing knob to lock the back angle

## Back Pad & Lumbar Pad

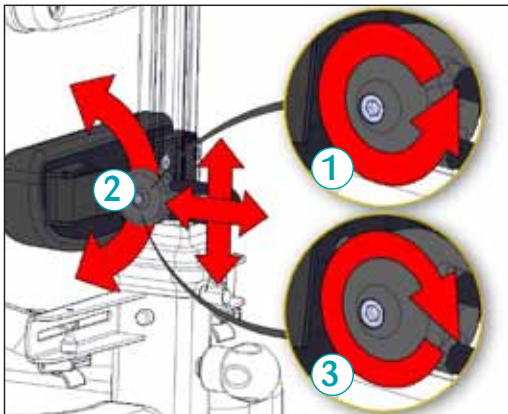

Loosen the locking wing knob

1. Back pad can be moved up & down the back post
2. Back pad can be moved away from & closer to the back post
3. Back pad angle in relation to the back post can be altered



NB The same method as above is used to alter the position of the lumbar pad

# Hip Guides



### Why? Benefits of the Adjustment:

The width of the hip guides should be set depending on the size of your child. The angle of these guides will help to keep your child's hips in a position with the correct amount of abduction or adduction

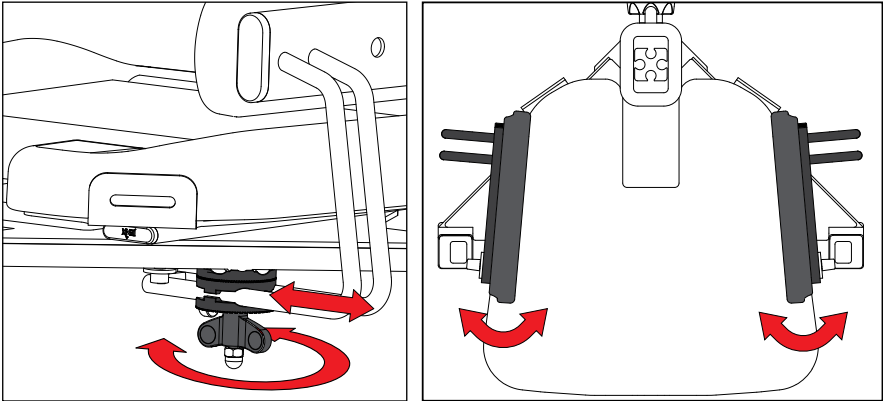

Loosen the wing knob under the seat and adjust the position and angle of the hip guide. Tighten the wing knob when the desired position is reached.

# Seat Depth

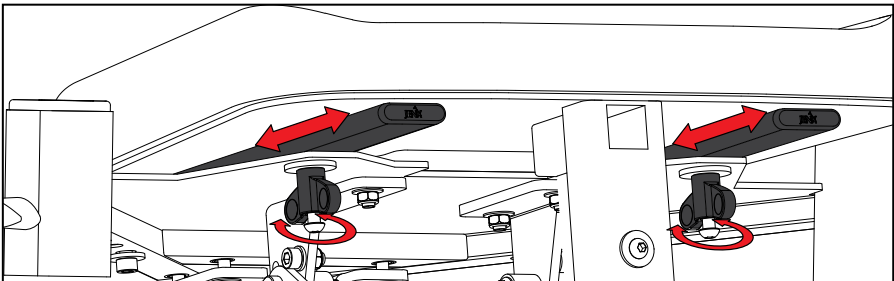

### Why? Benefits of the Adjustment:

Set the seat depth to suit the child's upper leg length. Ensure there is some space between the back of the knee and the front edge of the seat so that the sitting position is comfortable. As the child grows, adjust the seat depth accordingly

Loosen the wing knobs under the seat and slide the seat backwards or forwards. Tighten the wing knob when the desired position is reached.

# Seat Pad & Abduction Roll

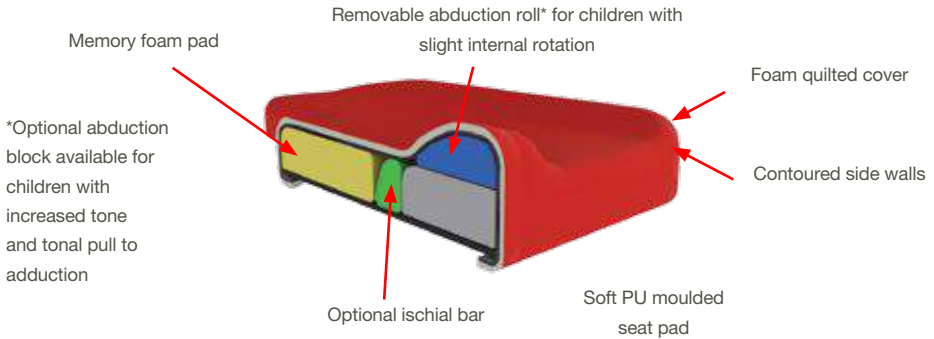

## Memory Foam Pad & Abduction Roll

### Why? Benefits of the Adjustment:

A removable abduction roll within the seat cushion combined with contoured cushion sides and hip pads, provides greater hip and leg control. Targeted use of memory foam increases comfort.

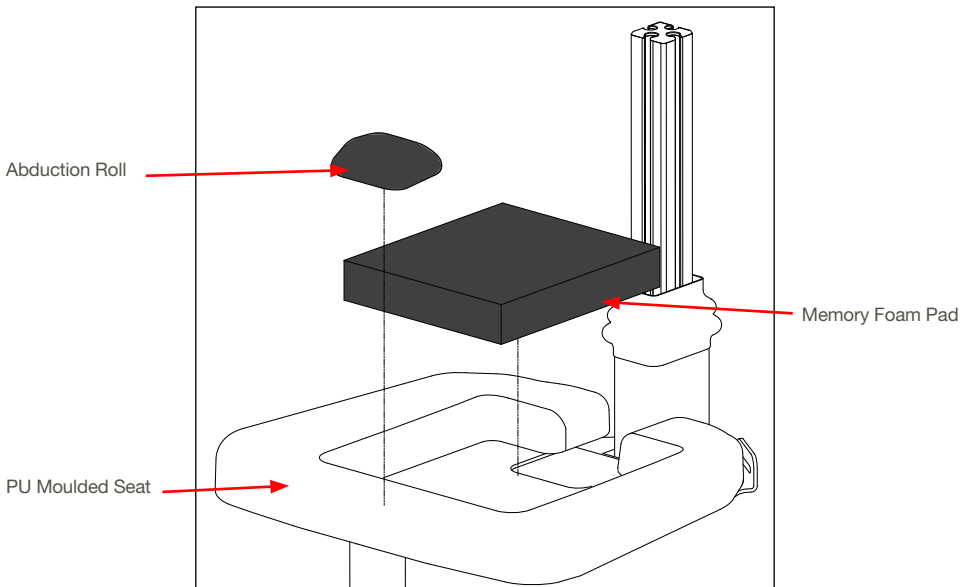

CHAPTER FOUR

# Optional Accessories



# Seat Extension



The seat extension fits onto the underside of the front of the chair, shown above

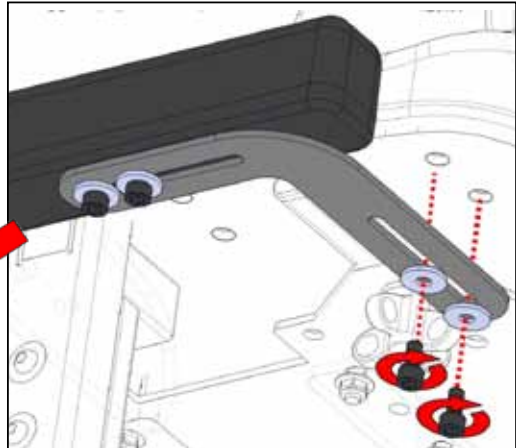

Insert the allen key bolts provided through the washer, the slot in the seat extension and into the holes in the underside of the seat and tighten with the allen key provided

## Adjusting the Seat Extension

**Step 1:** Loosen the allen key bolts (2 for the width adjustment and 2 for the depth)

**Step 2:** Adjust the width and depth of the seat extension

**Step 3:** Tighten the wingknobs, using the allen key provided

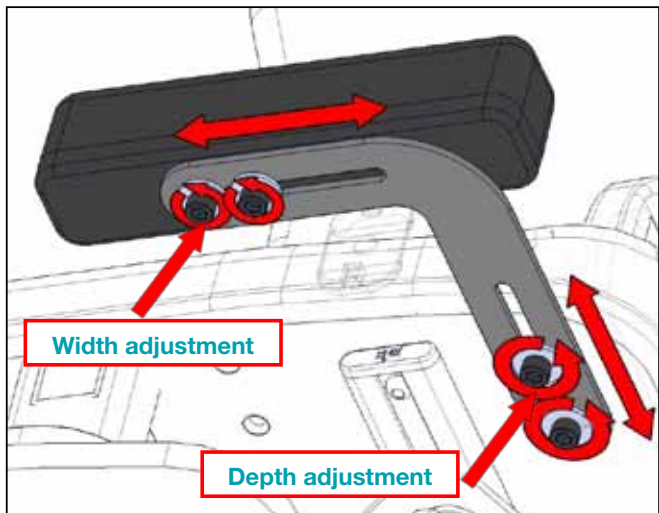

# Headrests



## Fitting the headrest (Multi Grip, Oval, PU Adaptable)

All of the Jenx headrests fit to the Junior chair in the same way, they also adjust for angle, depth and height in the same way.

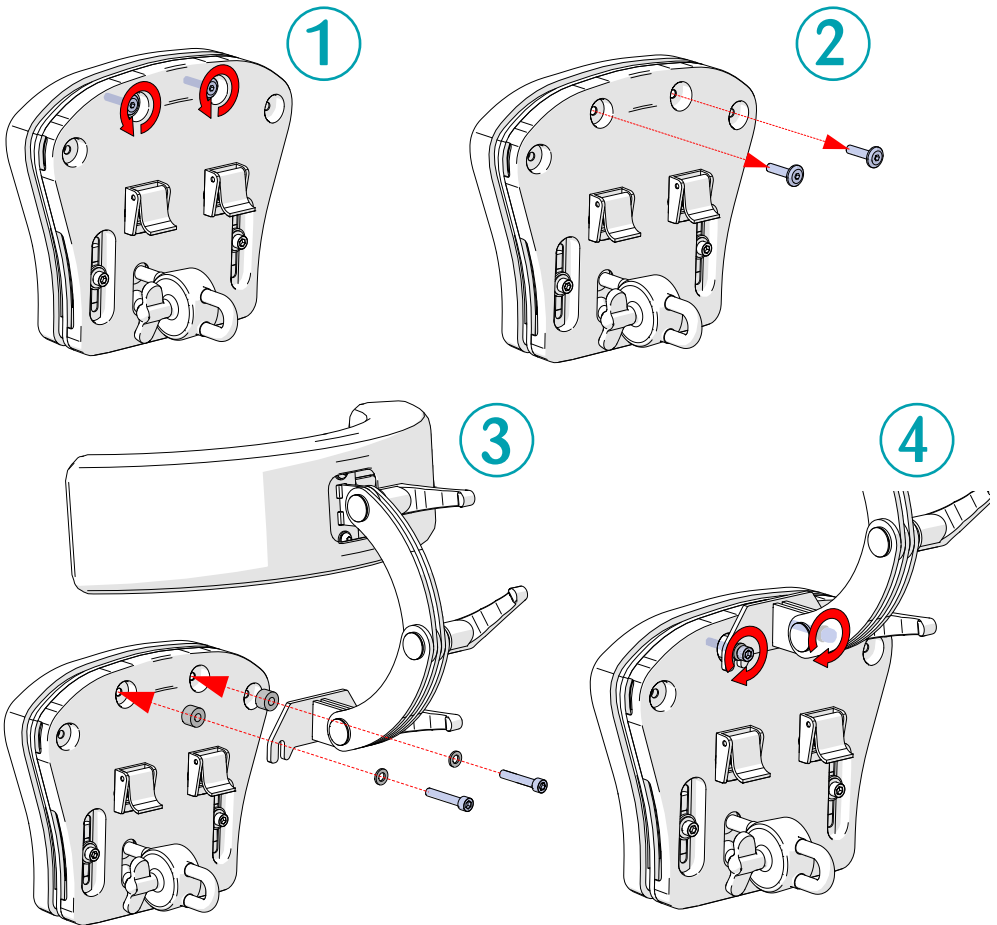



# Height angle & depth adjustment



Using the clamping lever: Loosen



**1:** Pull the lever out to disengage



**Step 2:** Keeping the lever pulled out, rotate the lever clockwise to the upper most position



**Step 3:** Release the lever



**Step 4:** Rotate the lever anti-clockwise to loosen. Repeat steps 1 to 4 to loosen further.

## General Information

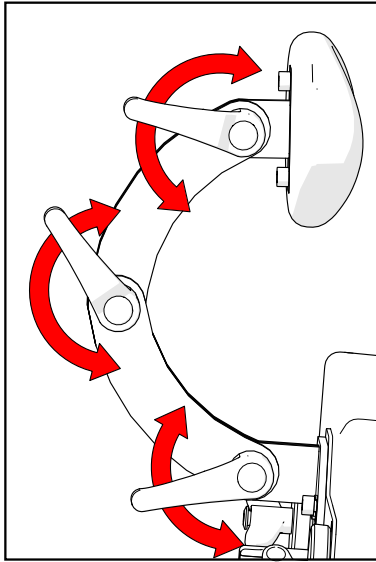

Adjust the angle of the joint that you have loosened



Always ensure levers are left in an appropriate and safe position



Ensure that the headrest is not set to a position that would enable the user to come into contact with the metal links

### Using the Clamping Lever: Tighten



**1:** Turn the lever clockwise to tighten.  
If the headrest needs further tightening continue to step 2.



**Step 2:** Pull the lever out to disengage the ratchet



**Step 3:** Turn the lever anti-clockwise



**Step 4:** Release the lever and return to step 1

# Multigrip Headrest

## Adjusting Multi-Grip Headrest

Use these bolts to adjust position of the Multi-Grip links

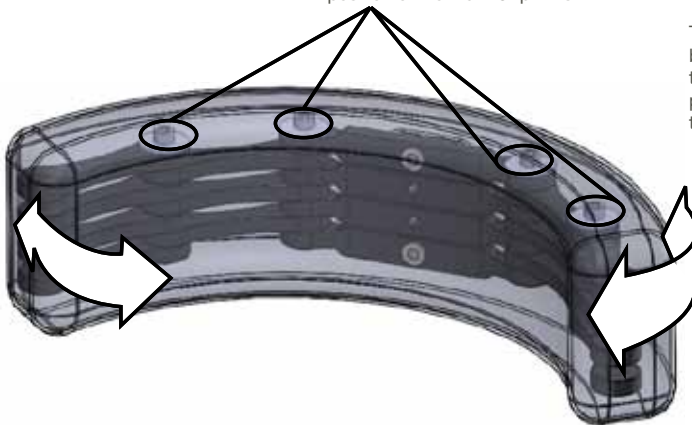

To move Multi Grip links under the bolts shown above. The links can then be easily moved to desired position. Once position is achieved tighten the bolts securely.

### Why? Benefits of the Adjustment:

The headrest should be positioned to support the child's head. For children with good head control, straighten out the multi-grips to provide a fairly smooth back surface. Never use the headrest to force a child's head into position as this will cause discomfort and can trigger reflexes which will result in poor posture. The unique Multi-grip™ supports can be moulded to the shape of the child and can be splayed at the end to support under the child's chin.

# PU Adjustable Headrest



## Moulding the PU Adjustable headrest (Size 1 and Size 2)

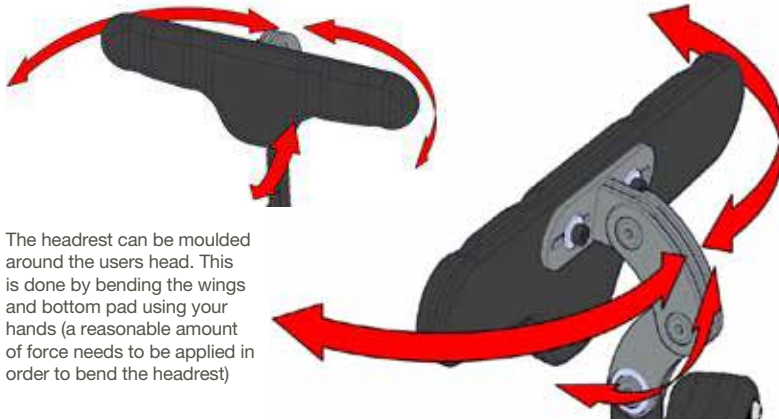

The headrest can be moulded around the users head. This is done by bending the wings and bottom pad using your hands (a reasonable amount of force needs to be applied in order to bend the headrest)

## Lateral Adjustment

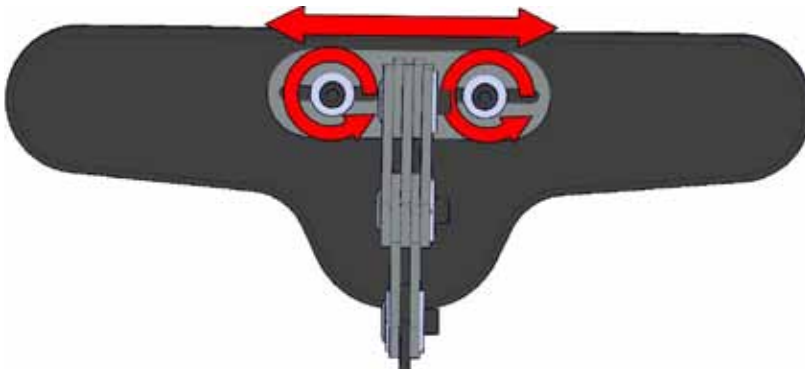

- Step 1:** Loosen the allen key bolts.
- Step 2:** Adjust the lateral position of the headrest
- Step 3:** Tighten the wingnuts

# Shoulder Protractors



**Step 1:** Insert the shoulder protractor into the slot at the top of the back pad

**Step 2:** Insert the allen key bolt through the washer and into the hole in the back of the back pad and tighten using the allen key supplied

**Step 3:** Repeat for the opposite side

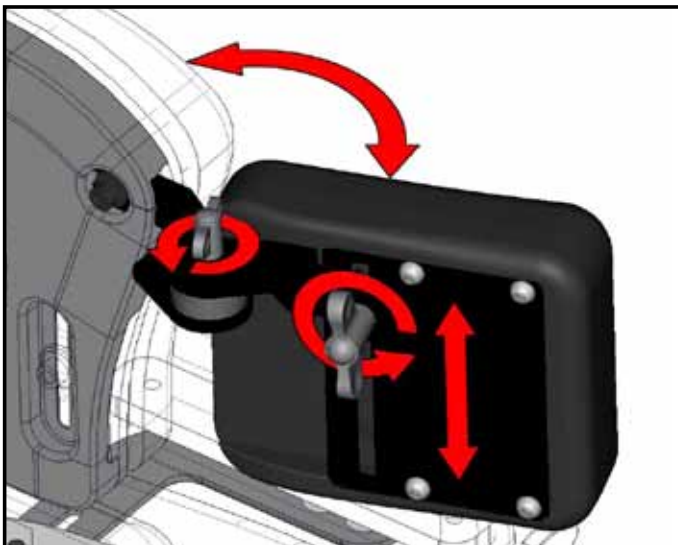

**Step 1:** Loosen wing knobs

**Step 2:** Adjust the angle and height of the pad

**Step 3:** Tighten the wing knobs

# Push Handle



## Fixed Push Handle



## Fitting the Push Handles

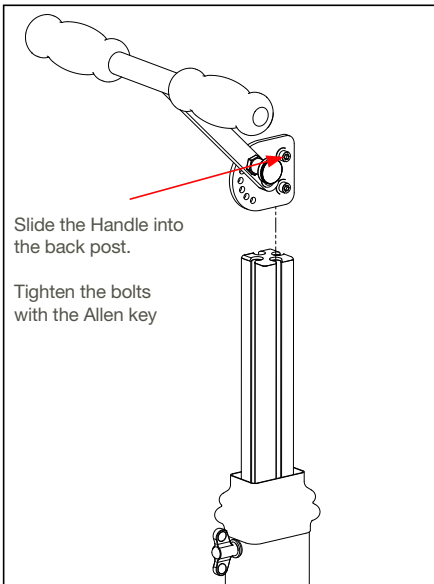

## Folding Push Handle

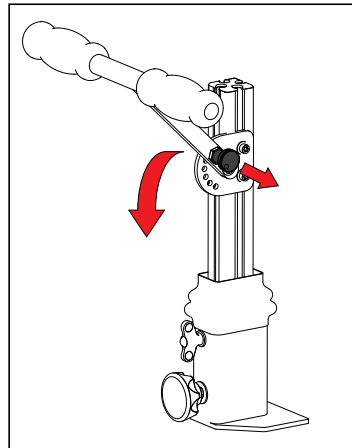

# Thoracics



## Fitting the Thoracics

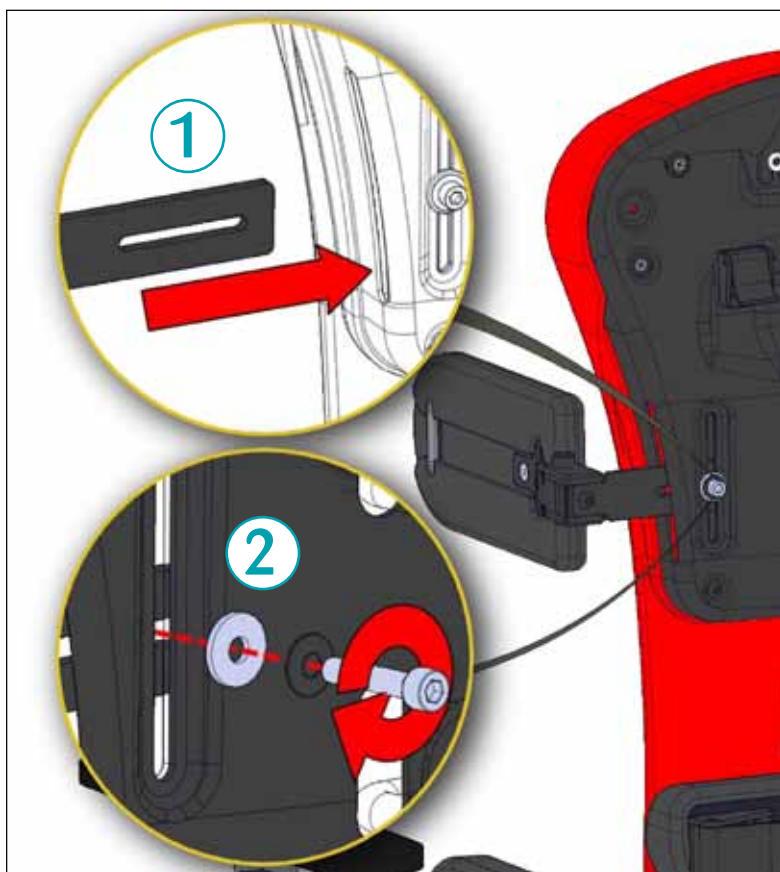

# Thoracic pads



Adjusting thoracic pads width and height

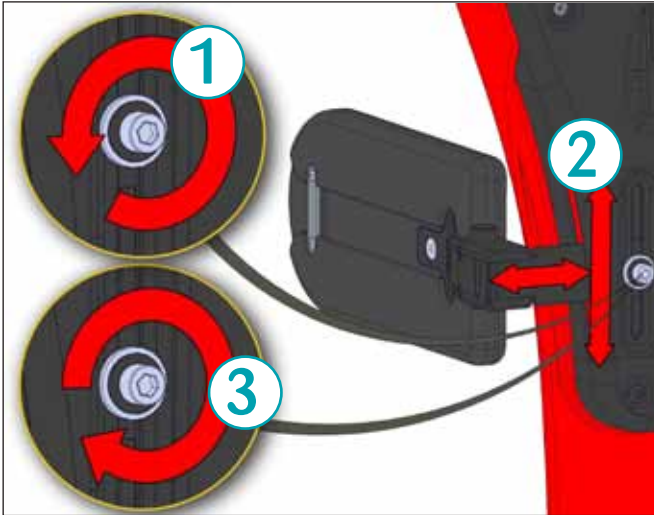

Adjusting thoracic angle (button release only)

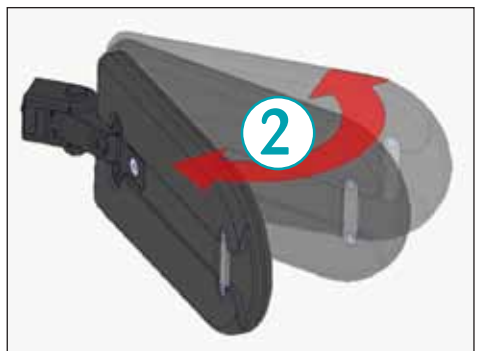



# Armrests



## Tray & Tray Arms Height & Angle Adjustment

### Why? Benefits of the Adjustment:

Tray height is adjusted for the following reasons:

To allow the child to have support from their arms

To allow the child to have support at the height that suits them for active work on the tray

To bring the tray in line with another surface where other children are working to increase social interaction

Tray angle is adjusted for the following reasons:

An increased angle can help children with their hand function for activities such as drawing or writing

An increased angle means that a child will tend to hold their head up better when using the tray

An increased angle will help some children to see their work more clearly as it will be more completely within their field of vision

## Adjusting Tray Arms

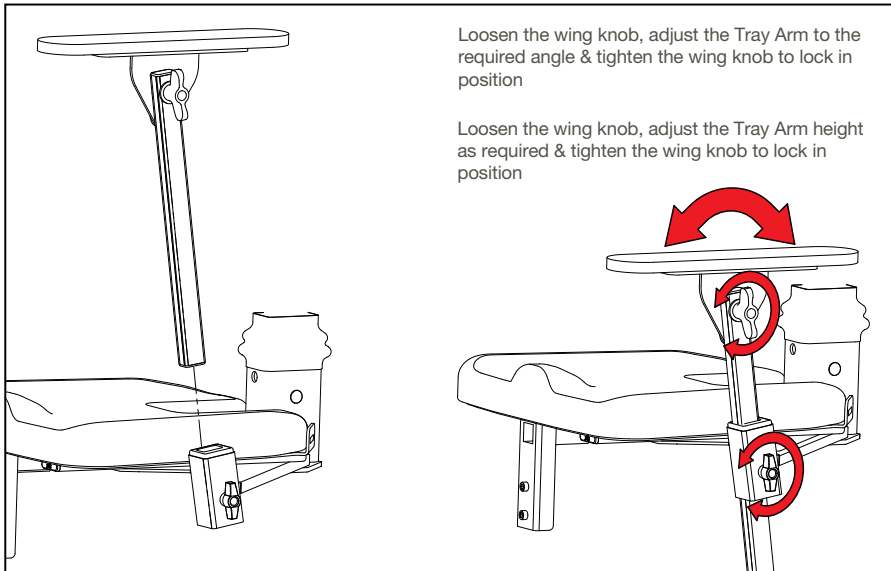

# Tray



## Fitting Tray

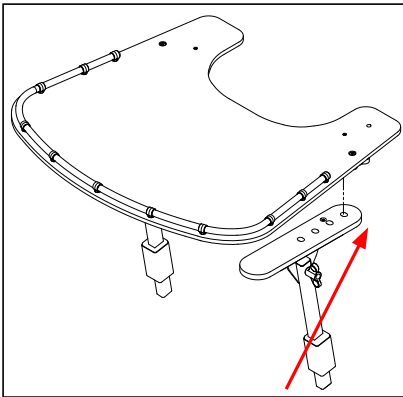

Fit the Tray Locating Pins, under the Tray, into one of the holes on each Tray Arm

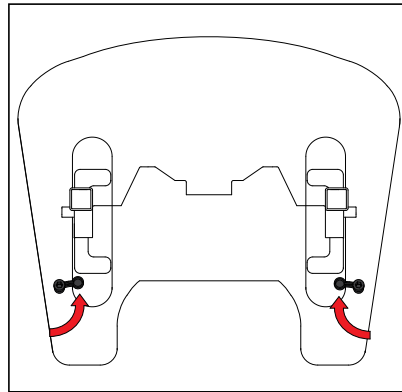

Push the Turn Buttons under the Tray Arms to secure the Tray

## Tray Infill (Grey)

### Why? Benefits of the Adjustment:

Tray infills are used to give a solid tray surface where the tray is pre-cut with a hole to take a bowl for play and tactile activities.

The translucent tray infills allows the child to still see communication stickers attached to the tray but to enjoy the benefit of a smooth surface for activities.

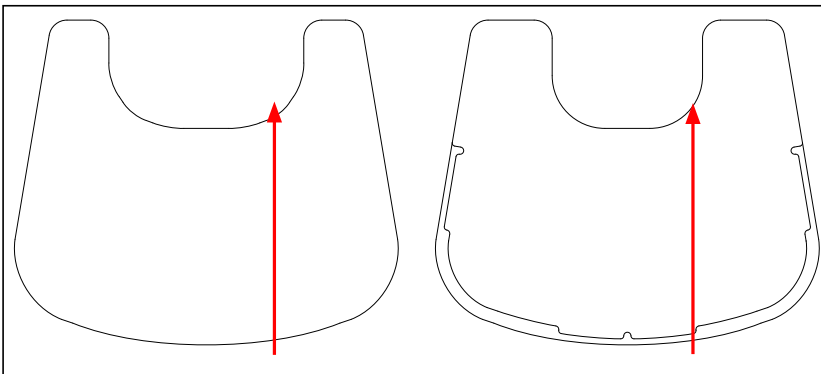

Shape of Tray with out Infill

Shape of Tray with Infill fitted showing difference in size of cut out

# Tray



## Translucent Infill for Tray

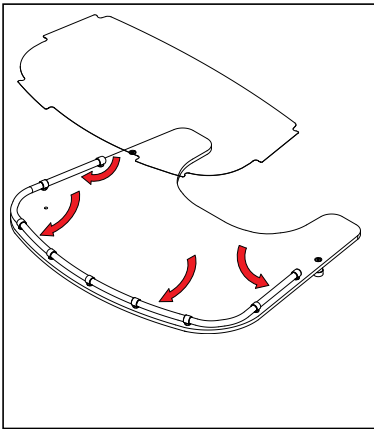

## Tray Pad

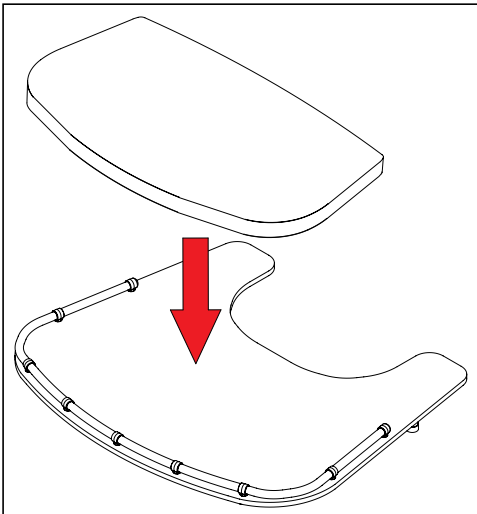

The Tray Pad is fitted to the Tray using Velcro®. The user decides where to position the pad and then sticks the self-adhesive Velcro® in the desired position.

# Activity Frame & Grab Bar



## Activity Frame

### Why? Benefits of the Adjustment:

Activity frames are added to the trays of both seating systems and standing systems to do one of two things: Hold toys near to the child to prevent them being lost.

Keep toys at a level where the child benefits most from the toy when they raise their head to see and play with them. In this way the activity frame helps to improve head control and also brings toys close enough to children for them to see them and interact with them as much as possible.

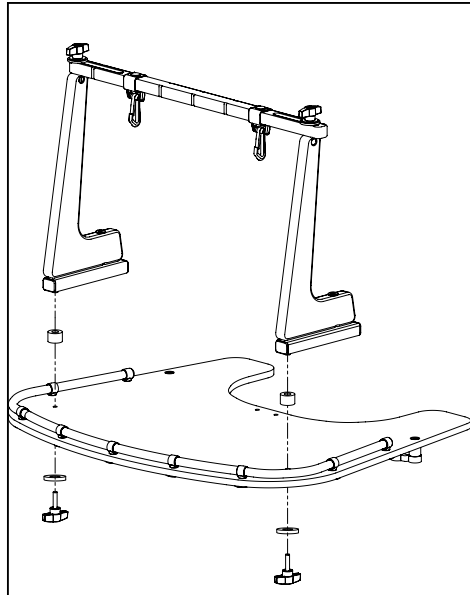

## Grab Bar

Grab bar fits in the same way as the activity frame

# Elbow Blocks & Chest Pad for Tray



## Tray Elbow Blocks

### Why? Benefits of the Adjustment:

Elbow blocks may fit to the tray or to the back of the chair and are used for children who pull their elbows back to prevent them doing this. Children's arms and hands are more functional when they are forward on the tray and elbow blocks help some children to achieve this.

**Step 1:** Place Elbow blocks over the tray

**Step 2:** Locate the countersink screws into the holes on the underside of the tray and into the Elbow blocks

**Step 3:** Tighten the screw with the allen key provided

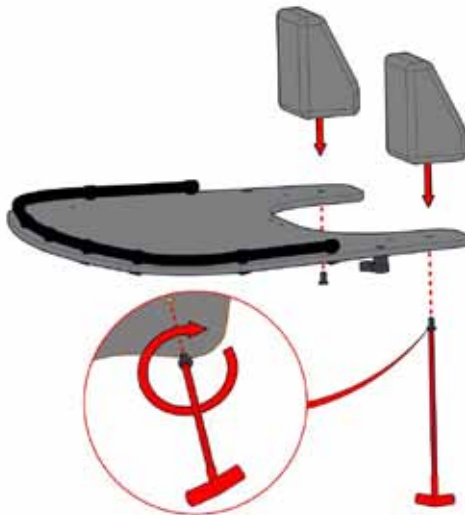

## Chest Pad for Tray

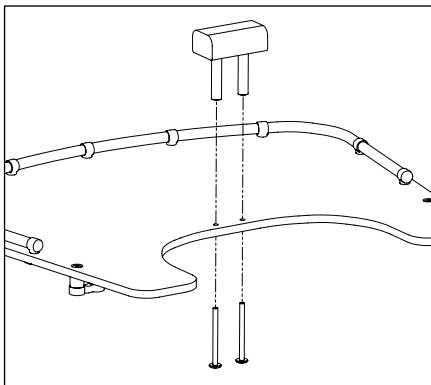

# Hip Pad Extension



**Why? Benefits of the Adjustment:**

Hip extension pads extend the amount of the child's thigh which is supported in sitting. These are often used for a child who tends to drop their thighs into external rotation in sitting. Used in conjunction with an abduction block these extension pads provide a gutter to support the whole of the child's thigh. This will help to keep the child's hips in a neutral or abducted position in sitting.

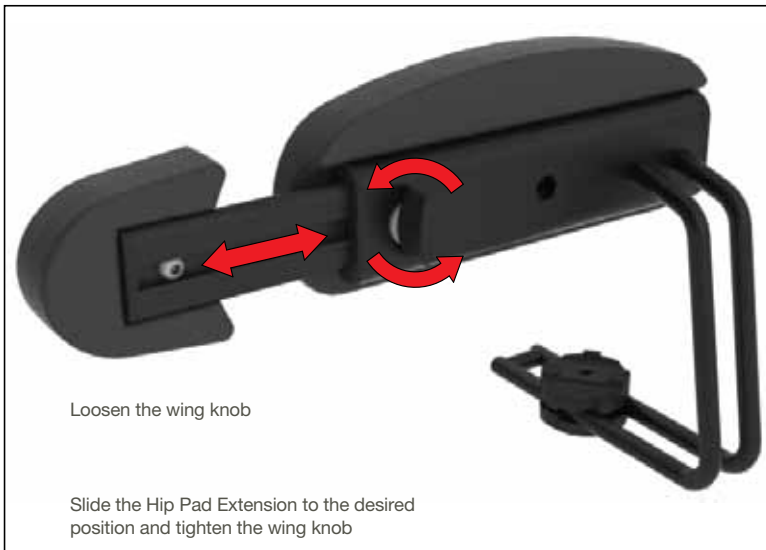
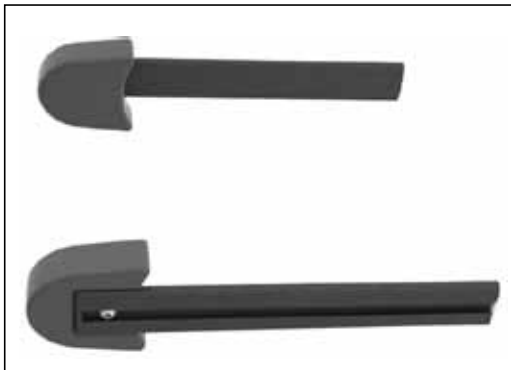

# Kneeblocks



## Knee Blocks

### Why? Benefits of the Adjustment:

Knee cups are used to hold the knees to encourage/maintain an abducted or neutral hip position in sitting.

! Knee cups are NOT used to push a child back into their seat. There should not be a strong force pushing towards the hips from the knee cups.

Knee cups should span the joint line of the child's knees to prevent strain on the knee. Too high and the knee cup only holds the femur which means that the tibia can still slide forward. Too low and the knee cup only holds the tibia which means that the femur can slide forward.



Loosen the wing knob & slide the bar to the desired length. Tighten the wing knob

Loosen the wing knob & slide the Knee Cup to the desired position. Tighten the wing knob

Pull the locking knob up to release the Knee Cup & rotate it out of the way. Release the locking knob into one of the holes to lock it in this position

# Abduction Block



**Why? Benefits of the Adjustment:**

This soft but firm block helps keep the knees apart and prevent adduction.

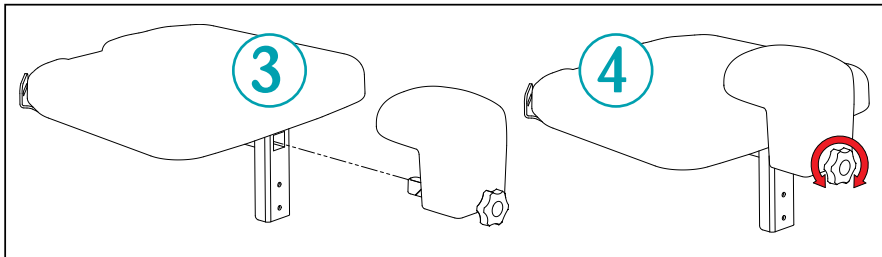

**Step 1:** Release the velcro of the cover and remove the abduction pad

**Step 2:** Put the cover back in place using the velcro

**Step 3:** Slide the abduction block post into the hole under the seat

**Step 4:** Tighten the scallop wheel to secure the Abduction Pad



# Sandals and Booties



## Sandals

### Why? Benefits of the Adjustment:

The sandals can be moved on the footplate to hold the child's feet. The most common position for the feet is directly below the knees.

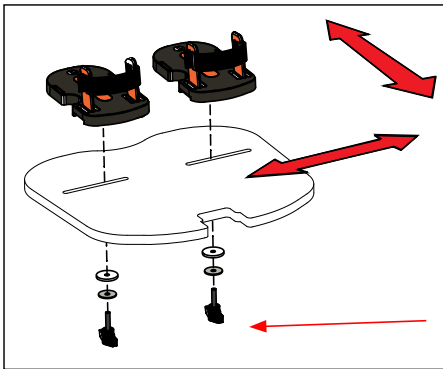

Sandal positions can be adjusted forward and backwards and from side to side.

Tighten the wing knobs when the Sandals are in the desired position

## Sandals and Sandal Raising Blocks

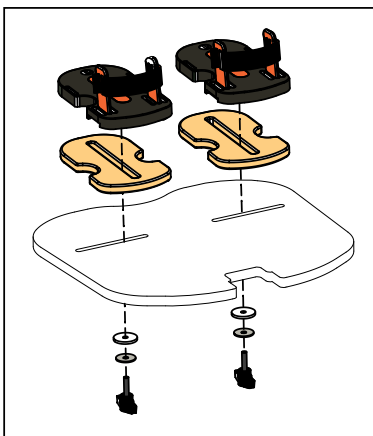

### Why? Benefits of the Adjustment:

Sandal raising blocks are used for two main reasons:

To compensate for an uneven lower leg length in a sitting child or overall leg length discrepancy in a standing child.

To reduce the lower leg or overall leg length of a particular product where the child is on the cusp between one size and the next to improve value for money. In this case the larger size product can be purchased but the sandal raising blocks mean that the child can use the product straight away and the blocks are removed as the child grows into the product.



Booties are fitted in the same way as sandals by fastening a wing nut through the foot plate into the fastening on the Bootie.

# Waistcoat Harness



## Fitting & Adjusting Waistcoat



Thread the top straps through the cam locks at the back of the back rest and close the cam locks.



Thread the bottom straps through the cam locks at the back of the seat and close the cam locks.



Open the zip and place the child in the chair. Close the zip again. Open the cam locks one at a time adjusting each strap until the Waistcoat is in the correct position and holds the child securely.

# Waistcoat Harness



Press the centre button to release the quick release buckles on the top and bottom straps

## Fitting Webbing Clips



Thread the webbing through the Webbing Clip as shown above



Squeeze the ends of the clips together until they click together



Webbing Clips must be fitted to the ends of the webbing on all four straps of the waistcoat

# Box Footplate

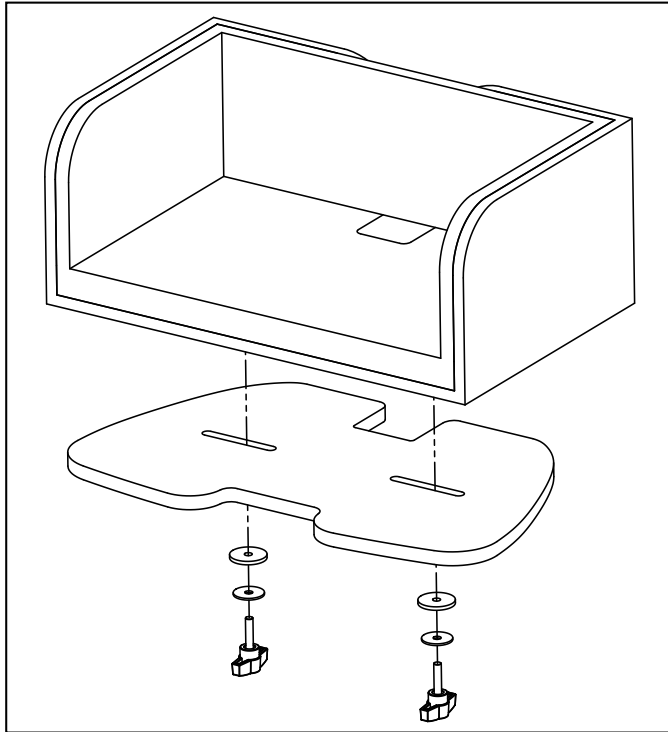

**Why? Benefits of the Adjustment:**

The box style footplate is used for children who find it difficult to keep their feet forward and tend to draw them back underneath the seat. The box prevents this whilst holding the feet in a secure position where partial weight bearing can be achieved.



CHAPTER FIVE

# Maintenance and Inspection



# Maintenance & Inspection



Each Jenx product must be checked and inspected in line with the advice given in this IFU. Failure to complete these regular checks poses a risk to the user. Every year, each product must be thoroughly inspected by a person competent to assess faults and able to rectify or out-source rectification. The maximum period that should elapse between full product inspections is 1 year. After 3 years or from purchase where a product is subject to heavy use, this should be increased to six monthly full inspections. For complete peace of mind, Jenx Limited offers Product Inspections. Charges apply

Jenx Limited products are usually assessed for an individual client, therefore the following points must be adhered to prior to the re-issuing of any Jenx products.

- Check with issuing Therapist that the product is standard and no special attachments or modifications have been made. If modifications have been made: contact Jenx Limited for advice
- Check that the product has been fully cleaned, taking into account the condition of the fabric and the foam inside
- Check that all hand wheels and levers are in good condition and fitted securely
- Check the product and any accessories fully for any sign of wear and tear or distortion
- Check that all the functions of the product are working correctly e.g. tilt, height adjustment or back recline, etc.
- Always ensure that the Instruction For Use stays with the product and is passed on to the new user. For new sets of instructions please contact our Sales Support Department on 0114 285 3376 or visit [www.jenx.com](http://www.jenx.com)
- If the product is being delivered, always ensure that the product is packed securely
- We strongly recommend that all straps and harnesses are replaced with new ones before re-issue. Only genuine Jenx parts should be fitted
- Check that gas spring levers are not bent. Do not use the product if any levers are bent. Contact Jenx Limited to arrange replacement
- Check that the product to be re-issued is to the correct specification for the intended new user. Each user may require different ranges of accessories

Follow the product log book document, supplied separately.

Use extra pages if required, extra sheets are available from the Jenx Limited website: [www.jenx.com](http://www.jenx.com)

# Maintenance & Inspection



Stores should follow the MHRA guidelines for the recording, issuing, servicing or repairing of products in their charge. Check the MHRA web site for the latest bulletins:  
[www.mhra.gov.uk](http://www.mhra.gov.uk)

- **Structure** Is the product structurally sound, no wobbles or loose parts?
- **Safety** Is the product safe and fit for use?
- **Straps** Are the straps in good condition and not showing any signs or wear? Check straps for fraying and missing or broken buckles, ensure all webbing end clips are in place.
- **Stability** Is the product stable on an even surface, no rocking?
- **Screws, Nuts and Bolts** Are there nuts and bolts missing or damaged?
- **Castors** Are the castors in good order? Do swivels and brakes work?
- **Springs** Do all gas springs work and hold pressure and weight?
- **Sandals** Are the sandals in good condition? Do straps and Velcro show signs of wear?
- **Upholstery and PU** Is the upholstery and PU in good, clean condition with no rips, wear or gaping of the cushions?
- **Steel and Woodwork** Is the steel and wood work in good order? Check for deformities, splinters or breaks

If there is any doubt about the safety of the product, do not hesitate to contact our Customer Support Department for advice

Products should be thoroughly decontaminated in line with MHRA and local guidelines prior to inspection, storage and re-issue

Jenx Limited can take no responsibility for re-issue of products

# Frequently Asked Questions



**Question:** Who is a qualified person to inspect products?

**Answer:** The purchasing authority has a duty under the MHRA guidelines DB2006 (05) to address training for Medical Devices Management. Check with your authority.

**Question:** Does Jenx run technical competency courses?

**Answer:** Yes. Please visit [jenx.com](http://jenx.com) for details of available courses.

**Question:** Why does my tilt-in-space lever not work?

**Answer:** If your lever does not operate properly, ensure that it is fully unlocked and try again. Do not use excessive force







## Notes









-  Seating
-  Standing
-  Sleeping
-  Therapy
-  Mobility
-  Bathroom

