

# Carrot 3000



## CAR SEAT

### AUSTRALIAN SCRIPTING AND ORDERING GUIDE

Distributed by  
**medifab**

# Client Details

Client/User Name:	
Date:	
NDIS/Funding:	

User Measurements	
A Hip width	
B Seat depth	
C Seat to top of shoulder	
D Seat to top of head	
E Chest width	
F Seat to axilla	
G Leg length	

**Get it Faster** 9999-ASMB-002

**Medifab Assembly Service for Easy Delivery**

Medifab offers our popular assembly service on this product, meaning the product arrives ready to be delivered, straight from the box, saving time and speeding up the delivery process.

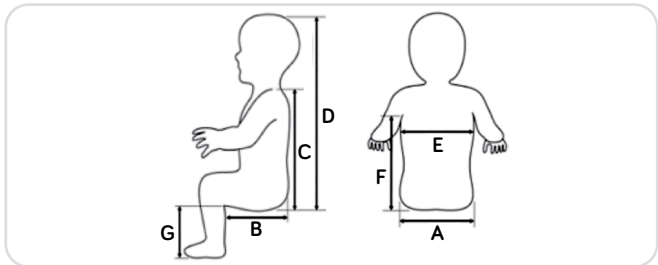

**Notes**

# Seat Specifications

Age Range	User Weight Range	Seat Depth	Shoulder Height	Seat Weight
3-15 years	13.6-49kg	25-40cm	32-47cm 45-60cm (when shoulder protector wings are added)	8.7kg

# Packages

Basic Packages:	Small		Large	
<ul style="list-style-type: none"> <li>Carrot seat unit</li> <li>5-point harness</li> <li>Headrest wings</li> <li>Tee-pad</li> <li>Free recline backrest</li> </ul>	4116-0010-259		Larger chest pad and deep headrest wings. 4116-0000-259	
Behavioural Packages:	Small		Large - larger tee pad and deep headrest wings	
<ul style="list-style-type: none"> <li>Carrot seat unit</li> <li>5-point harness</li> <li>Headrest wings</li> <li>Tee-pad</li> <li>Free recline backrest</li> </ul>	Small package with anti-escape buckle. 4116-0010-026		Large package with anti-escape buckle. 4116-0000-026	
	Small package with pen-key buckle. 4116-0010-025		Large package with pen-key buckle. 4116-0000-025	

**Swivel Base Attachment**

ISOfix essential.  
 (Standard adjustment of mandatory footprop is 34cm-40cm, if this is too short please contact Medifab Customer Service for Quote).  
 4116-0180-104



**Swivel Base Protection Plate**

Foam plate to protect car seat cover, mounts under swivel base.  
 4116-0190-000



# Seat Depth Growth

For growth, please select one of the following 3 rodded options, and associated extensions below, if required:  
 (Rodded components cannot be used in combination with each other).

## Option 1

**Rodded 50mm Seat Depth Extension**

4116-0281-259

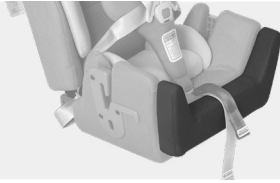

**50mm Growth Pad**

4116-0285-259



## Option 2

**Rodded Waterfall Seat Depth Extension**

4116-0283-259

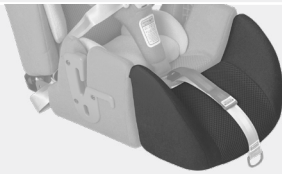

**50mm Growth Pad\***

4116-0285-259



**100mm Growth Pad\***

4116-0289-259

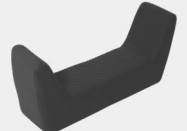

## Option 3

**Rodded Foot Support**

**Small**

Lower leg (D): 25-30 cm  
 4116-5241-250

**Medium**

Lower leg (D): 30-40 cm  
 4116-5242-250

**Large**

Lower leg (D): 40-50 cm  
 4116-5243-250



**50mm Growth Pad\***

4116-0285-259



**100mm Growth Pad\***

4116-0289-259

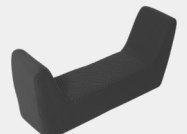

**Adaptor**

For use of foot support with swivel base.  
 4116-5120-000



\*50mm and 100mm growth pads cannot be used in combination with each other.

# Back Support Height Growth





50mm Height Extension	100mm Height Extension	Shoulder Protector Wings
<p>50mm back support height extension infill pad. 4116-2481-259</p> 	<p>100mm back support height extension infill pad. 4116-2482-259</p> 	<p>(For children over 45cm shoulder height). 4116-2753-259</p> 

\*50mm and 100mm infill pads cannot be used in combination with each other





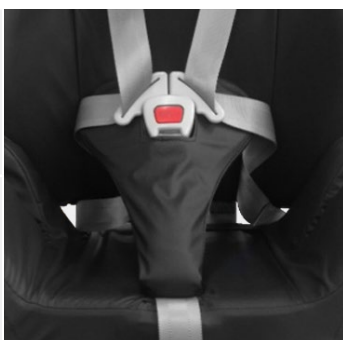



# Installation Accessories

Tether Strap (Optional)	ISOfix Lower Straps (Optional)	Airplane Fixing Strap
<p>No installation option removes the need for the vehicle safety belt to be used, this must be used in every situation. 4116-6953-017</p> 	<p>No installation option removes the need for the vehicle safety belt to be used, this must be used in every situation. 4116-6910-000</p> 	<p>Required for securing to aircraft seat. 4116-6960-017</p> 

# Cover Options

Wipe-down		
<p><b>Wipe-down seat base</b> 4116-0476-209</p>		<p><b>Tee-pad, Standard</b> 4116-6553-209</p>
<p><b>Wipe-down backrest</b> (Main unit only). 4116-2476-209</p>		<p><b>Tee-pad, Large</b> 4116-6558-209</p> 
Removable Incontinence Cover	Air Mesh Cushion Pad	
<p>Attaches using Velcro. Unable to be attached to wipe down covers. 4116-0475-209</p> 	<p>Attaches using Velcro. Unable to be attached to wipe down covers. 4116-8880-099</p>	

# Accessories (continued)

Tray / Forearm Support		Tilt Wedge	Upgraded Lateral Supports	
4116-5534-259		Provides 20° tilt. 4116-0291-259		Firm padding for added trunk control. 4116-3250-090
Seat Belt Holder		Shoulder Strap Retainer		
Designed to keep seat belt away from the neck. 4116-6790-017		<b>Small</b> Chest Circumference 55-70cm 4116-6721-000		
		<b>Medium</b> Chest Circumference 70-90cm 4116-6722-000		
		<b>Large</b> Chest Circumference 90-100cm 4116-6723-000		
Medial Thigh Support		Hinge Locking Belt		
Detachable & Washable. Attaches to chest support and crotch strap. 4116-1510-000		For easy carrying. 4116-8170-000		
Hip Belt		Accessory Cross Strap		
<b>Small</b> 4116-6531-027		<b>Anti-Escape</b> 4604-3004-026		
<b>Medium</b> 4116-6532-027		<b>Pen Release</b> 4604-3004-025		
<b>Large</b> 4116-6533-027		<b>Side Release</b> 4604-3112-019		



# medifab

Distributed by Medifab Ltd

[solutions@medifab.com](mailto:solutions@medifab.com)

[medifab.com](http://medifab.com)



DISTRIBUTED BY:

Script: Carrot\_20241030\_AU